

KDB / VG 95234 Series

Contents

Introduction	2
Connector design	2
Technical data	3
Mounting dimensions	5
How to order	7
Contact arrangements	9
Connector dimensions	27
KDB 00EP	27
KDB 06EW	28
KDB 00E	30
KDB 02E	32
KDB 020	32
KDB 02E	33
KDB TB	33
KDB 07	34
KDB 01E	35
KDB 06E	36
KDB 08E	37
Accessories	38
Contacts	40
Cross Reference Lists	41

KDB / VG 95234 Series

Introduction

The KDB circular Bayonet coupling connector series was designed in accordance with VG 95234 specification. This highly reliable connector series is an improvement on the well established MIL-DTL-5015 type.

The KDB series has a proven bayonet coupling design that offers exceptional vibration protected sealing against fluid, and easy connection/disconnection. This KDB series designed standard connector for application in ground fighting equipments.

Connectors in accordance with VG 95234 are interchangeable with the corresponding MIL-DTL-5015 connectors. Both connector lines feature the same shell dimensions and contacts layouts. However, due to the different coupling systems(MIL-DTL-5015 threaded coupling, VG 95234 bayonet coupling) they are not intermateable.

Advantages;

- rugged shell design
- environmental
- bayonet coupling for easy mating and unmating
- vibration proof
- waterproof up to 1 bar(35 feet of water)

Connector design

Due to the very rugged shell designs in aluminium alloy, this connector complies with the heavy duty and environmental requirements of military equipment. They also withstand abuse during servicing.

The olive drab chromate and cadmium plated finish protects the shell against environmental influences.

Insulators, grommets and O-rings are made of high quality polychloroprene and withstand temperatures from -55°C to 125°C. In addition, they are resistant against hydraulic fluids, jet fuel, diesel fuel, gasolines, lubricants and fire extinguisher fluids, and also meet the requirements of UL-95 self extinguishing.

The contacts, made of copper alloy plated with a hard silver finish guarantee at least 500 mating cycles.

All solder contacts are pretinned and enable fast and high quality soldering. The crimp contacts allow highly reliable crimping with wires according to TL6145-009, TL6145-011 and MIL-W-5086 when using the recommended tools according to VG 95234. All crimp contacts can be exchanged at least five times due to the contact retention.

The bayonet design allows very fast and easy coupling and uncoupling. After a 120° turn of the coupling nut, the roller bolt snaps-in into the locking position of the bayonet groove with a metallic sound. In addition to this audible snap-in, the locked position is marked by colored arrows.

KDB connectors are basically designed for single wire harnessing. Under certain conditions, jacketed cables can be used for the shell styles E, G, M and N.

For full environmental sealing each conductor is sealed completely within the special sealing grommet.

KDB / VG 95234 Series

Technical Data

Electrical Data

Contact rating at +20°C

Contact size AWG	current max. A
20	8
16	22
12	41
8	74
4	135
0	245

Current rating

depending on ambient temperature

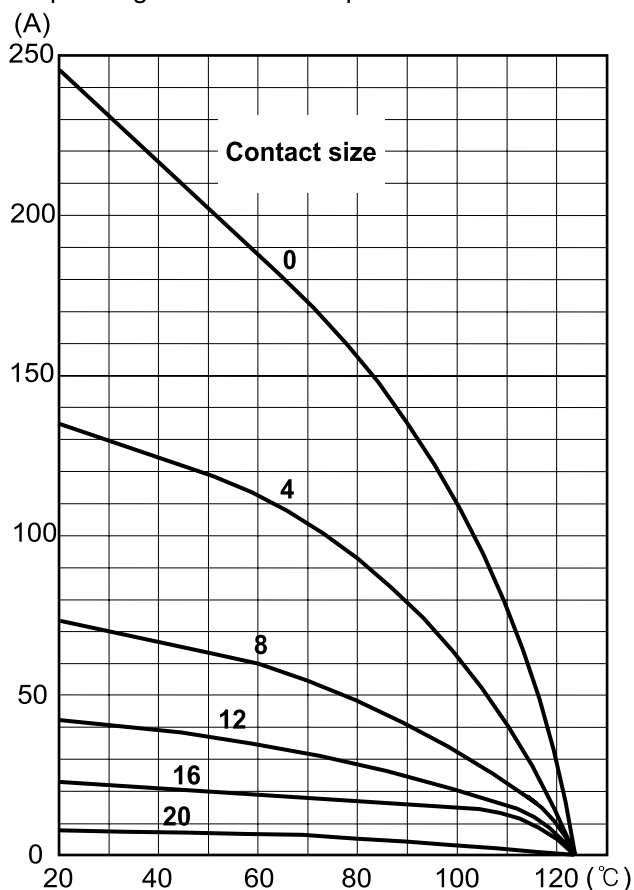

Contact resistance

The measurement of contact resistance has to be tested according to VG 95319 Part 2, test no 5.10.1 and VG 95210 part 37. milliohm - test;

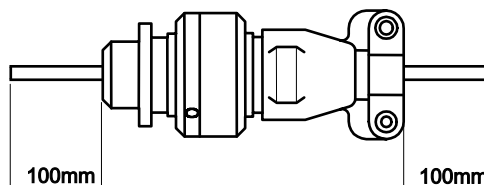

Contact size AWG	contact resistance max. mΩ
20	12
16	6
12	3
8	1
4	0.5
0	0.2

Insulation resistance

The insulation resistance has to be tested according to VG 95319 Part 2, test no 5.12 and VG 95210 Part 32, test condition B; DC 500V/1000 MΩ min.

Test voltage

The dielectric withstanding voltage has to be tested according to VG 95319 Part 2, test no 5.13 and VG 95210 Part 31. Test voltage for service rating;

Service rating	Test voltage Vrms
Instruments	1050
A	1600
B	4000
D	2500
E	3000

KDB / VG 95234Series

Mechanical Features

Ambient temperature

-55 / +125°C

Safety provisions

IP 67 according to DIN 40050
(1 bar pressure after 12 hrs.)

Vibration test

200 m/s at 10 to 2000Hz

Mating cycles

500 cycle.

Separating force per contact

The corresponding separating force has to be measured according to VG 95319 Part 2, test no 5.7 using the required test gage.

Contact size AWG	Separating force	
	min. N	Gage
20	0.3	G 0.99
16	1.0	G 1.56
12	1.5	G 2.36
8	3.0	G 3.58
4	4.0	G 5.69
0	8.5	G 9.04

Gage

(See also VG 95234 Part 1)

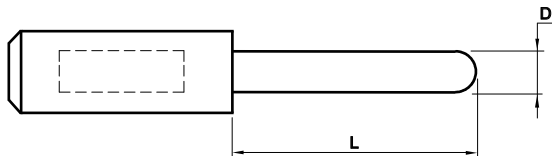

Gage	Contact diameter D	L
	+0.01	-1.0
G 0.99	0.99	7.0
G 1.56	1.56	9.0
G 2.36	2.36	12.0
G 3.58	3.58	13.0
G 5.69	5.69	13.0
G 9.04	9.04	13.0

Coupling torque

The allowable coupling torques have to be tested under full bundle conditions of the connectors according to VG 95319 Part 2, test no 5.8.2

Shell size	Allowable coupling torque	
	closing and opening max. N-m	Opening min. N-m
10SL	1.7	0.15
12S	2.5	0.23
14S	3.6	0.35
16S/16	5.5	0.46
18	8.0	0.58
20	9.0	0.70
22	11.0	0.80
24	14.0	0.80
28	17.0	0.92
32	19.0	1.03
36	23.0	1.03

Contact retention

The contact retention has to be tested according to VG 95319 Part 2, test no 5.4

Test force direction = Mating direction

Contact size AWG	Test force N
20	30
16	35
12	55
8	80
4	90
0	95

Materials

Shell

Material Aluminum alloy
Finish Olive drab chromate coating over cadmium plating

Insulator and grommets

Polychloroprene

Contacts

Material Copper alloy
Finish hard silver

KDB / VG 95234 Series

Mounting Dimensions

Mounting holes

Mounting holes for wall mounting receptacles style A, B1, B2, C1, C2, J1, J2, N1, N2, U1 and U2 according to VG 95234 or KDB 00E/F/R and KDB 02E.

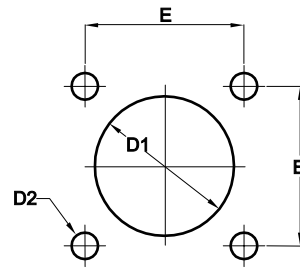

Shell size	∅D1		∅D2		E ±0.15	Screws to be used	
	KDB 02E	KDB 00EP KDB 00E, F, R KDB TB /-05 KDB 05	Mod.03/.05/.09	KDB 00EP KDB 00E, F, R KDB TB /-05 KDB 05 Mod.08		Mod.03/.05/.09	KDB 00EP KDB 00E, F, R KDB TB /-05 KDB 05 Mod.08
	A	B1, B2, C1, C2, J1, J2, N1, N2, U1, U2	A, B2, C2, J2, N2, U2	B1, C1, J1, N1, U1		A, B2, C2, J2, N2, U2	B1, C1, J1, N1, U1
10SL	16.7	18.7	3.4	4.5	18.20	M3	M4
12S	16.7	21.9	3.4	4.5	20.60	M3	M4
14S	19.7	25.1	3.4	4.5	23.00	M3	M4
16S	22.9	27.9	3.4	4.5	24.60	M3	M4
16	22.9	27.9	3.4	4.5	24.60	M3	M4
18	26.1	31.3	3.4	4.5	27.00	M3	M4
20	29.5	34.7	3.4	4.5	29.40	M3	M4
22	32.7	37.9	3.4	4.5	31.80	M3	M4
24	35.8	41.4	3.9	4.5	34.90	M3.5	M4
28	41.9	47.2	3.9	5.5	39.70	M3.5	M5
32	48.3	53.9	4.5	5.5	44.50	M4	M5
36	54.6	60.1	4.5	5.5	49.20	M4	M5

Wire stripping

Either mechanical or hot stripping can be used. Prevent conductor damage.

Note : Do not twist conductors used with crimp contacts. Do not touch uninsulated conductors before crimping. Twisting of conductors and grease or lubricants on the wires cause poor crimp quality.

Contact size AWG	Stripping length mm
20	4.0
16	6.2
12	6.2
8	11.8
4	11.8
0	13.7

Harnessing

All other wires have to conform to wire with the data given in the following table.

Contact size AWG	Metric mm ²	∅ Conductor mm
20	0.75 - 1.0	1.0 - 1.4
16	1.0 - 1.5	1.25 - 1.7
12	2.5	1.95 - 2.4
8	10.0	4.3 - 4.8
4	16.0	5.2 - 6.0
0	50.0	9.6 - 10.7

KDB / VG 95234 Series

Separating and mounting dimensions

When using connectors according to VG 95234 the below mentioned installation dimensions have to be met.

KDB 06E
KDB 06F -15
Connector style D

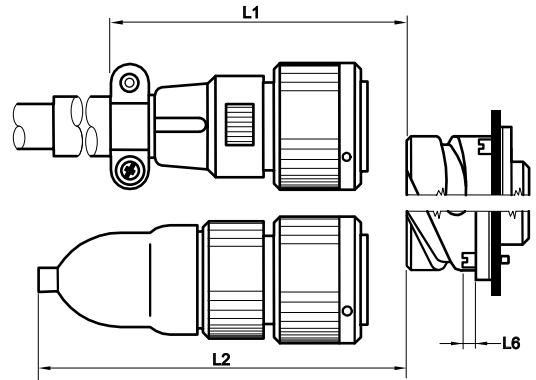

KDB 06E -02 / -15
Connector style G and M
with shrink boot straight according to VG 95343

KDB 08E
KDB 08F -15
Connector style E

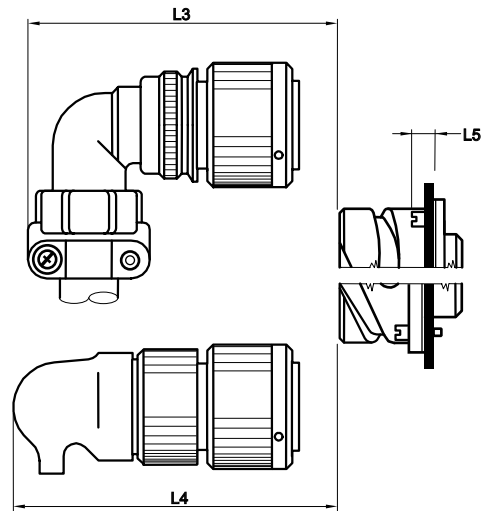

KDB 06E -02 / -15
Connector style G and M
with shrink boot 90° according to VG 95343

Shell size	L1 min	L2 min	L3 min	L4 min	L5 max	L6 max
10SL	70.0	70.0	70.0	65.0	8.0	3.5
12S	70.0	75.0	75.0	70.0	8.0	3.5
14S	70.0	75.0	75.0	70.0	8.0	3.5
16S	70.0	90.0	80.0	80.0	8.0	3.5
16	80.0	100.0	90.0	90.0	8.0	3.5
18	90.0	100.0	90.0	90.0	8.0	3.5
20	90.0	100.0	95.0	100.0	8.0	3.5
22	90.0	100.0	95.0	100.0	8.0	3.5
24	110.0	120.0	105.0	110.0	8.0	5.0
28	110.0	120.0	105.0	110.0	9.0	5.0
32	110.0	180.0	115.0	120.0	9.0	6.0
36	110.0	190.0	120.0	130.0	9.0	6.0

KDB / VG 95234 Series

How to order

KDB Order Reference

KDB Standard

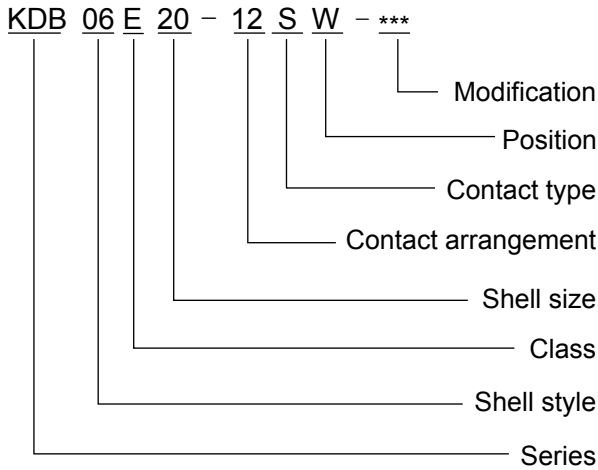

Explanations

Series

KDB Kukdong Circular connectors with bayonet coupling

Shell style

- 00 Wall mounting receptacle
- 01 Cable connecting plug
- 02 Box mounting receptacle
- 05 Dummy receptacle for front and panel mounting
- 06 Plug, straight
- 08 Plug, 90° angle
- 07A Jam nut receptacle
- 07G Jam nut receptacle with RFI/EMI shielded coil within receptacle shell
- 070A Jam nut receptacle with threaded real for accessories
- 070G Jam nut receptacle with threaded real for accesories and RFI/EMI shielded coil whitin receptacle shell
- TB Thru-bulkhead receptacle

Class

- E environmental with resilient insulators and endbell with clamp and bushing
- F environmental with resilient insulator and endbell for flex tube
- 00EP - TLxx Tinel-Lock adapter
- 06EW - TLxx Tinel-Lock adapter
- 00EP - ZLxx Zetalok adapter
- 06EW - ZLxx Zetalok adapter

Shell size

10SL, 12S, 14S, 16S, 16, 18, 20, 22, 24, 28, 32, 36

Contact arrangement

see pages 13-26

Contact type

- P - Pin contact
- S - Socket contact
- PS - one side pin, one side socket(only for TB)

Position

See pages 9-12

Modification

- 02 adapter for shrink boots, AWG crimp contacts
- 05 rear mounting through holes in flange (KDB 00, 02E, TB)
- 08 90° angle shell, threaded holes in flange (KDB 00)
- 09 90° angle, 4 through holes(KDB 00)
- 15 endbell for shielded cables and heat shrink boots, AWG crimp contacts
- 109 F80 rear mount with four threaded holes (for receptacles only)
- F80 AWG crimp contacts

Angle

1 - 0° 2 - 45° 3 - 90°

Entry size

see page 29

KDB Special

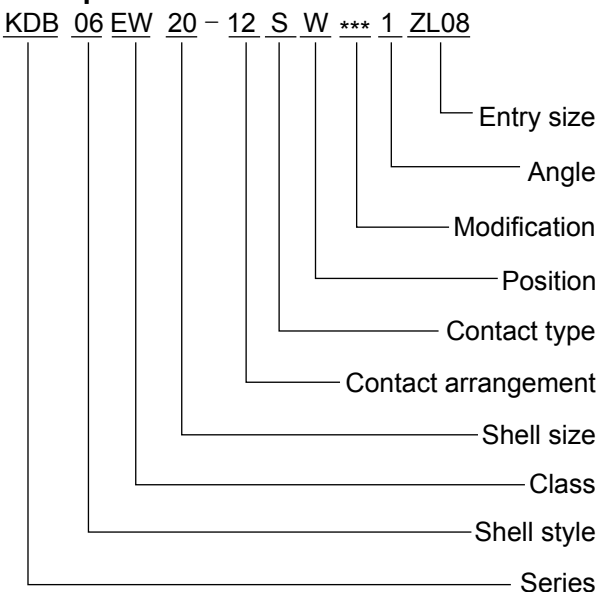

KDB / VG 95234 Series

VG Order Reference

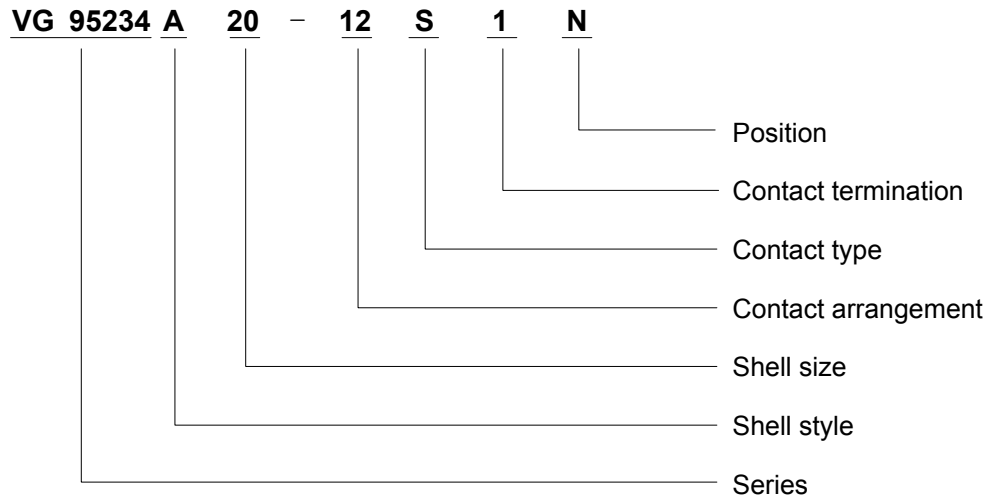

Explanations

Position

The VG 95234 specification includes two additional insert positions X and Y to prevent mismatching when using more than one connector with same shell size and layout. The position is achieved by turning the inserts clockwise (pin connector) and counterclockwise (socket connector) to the basic position.

Contact termination

identification 1 - contact for AWG wire sizes

Contact type

P - Pin contact

S - Socket contact

PS - One side pin, one side socket(only for TB)

Contact arrangement

All contact arrangements are shown on pages 9 - 26. The reference in bold type under each contact layout identifies the contact arrangement. The first two digits indicate the shell size; the second part of the reference defines the contact arrangement, which, however, is not always identical with the number of contacts.

The capital letters in the lowest line indicate the service rating according to MIL-DTL-5015.

Shell size

Shell sizes 10SL to 36

Shell style

See pages 27 to 37

Series

Number of specification

Important

When ordering connectors according to VG 95234, however in modified versions, for example with special finish, other contact arrangements or solder contacts, please use only the Kukdong designation.

KDB / VG 95234 Series

Contact Arrangements

Alternate Insert Positions

※ View shows pin front side or socket rear side

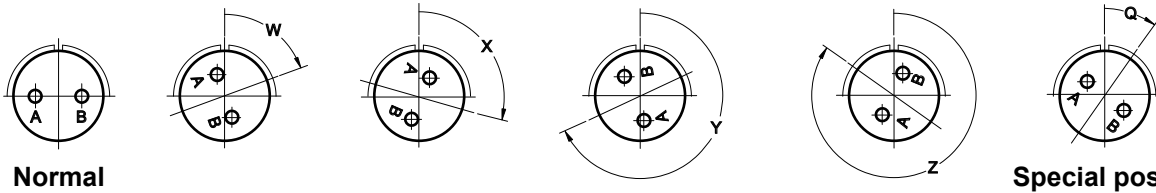

Shell size	Insert Number	Contacts								Alternate Pos.				Spec Pos.	
		Tot	0	4	8	12	16	20	W	X	Y	Z	No.	Q	
10SL	10SL-3	3					3								
	10SL-4	2					2								
12S	12S-3	2					2	70	145	215	290				
	12S-1 ★	2					2					12	100		
	12S-2 ★	2					2					8	250		
	12S-4	1					1								
	12SA10	4					4					3	110		
	12SA10	4					4					8	250		
12	12-5	1				1									
14S	14S-1	3					3								
	14S-12 ★	3					3					12	100		
	14S-13 ★	3					3					2	260		
	14S-2	4					4		120	240					
	14S-10 ★	4					4					12	100		
	14S-11 ★	4					4					13	250		
	14S-14 ★	4					4					2	260		
	14S-4	1					1								
	14S-5	5					5			110					
	14S-6	6					6								
	14S-7	3					3	90	180	270					
	14S-9	2					2	70	145	215	290				
	14SA7	7					7								
	14SA10	10					10								
16S	16S-1	7					7	80				280			
	16SA18★	7					7					12	100		
	16SA20★	7					7					3	110		
	16SA21★	7					7					13	250		
	16SA19★	7					7					2	260		
	16S-4	2					2	35	110	250	325				
	16S-15 ★	2					2					12	100		
	16S-5	3					3	70	145	215	290				
16S-8	5					5		170	265						
16	16-7	3			1		2	80	110	250	280				
	16-9	4				2	2	35	110	250	325				

Shell size	Insert Number	Contacts								Alternate Pos.				Spec Pos.		
		Tot	0	4	8	12	16	20	W	X	Y	Z	No.	Q		
16	16-10	3					3					90	180	270		
	16-11	2					2					35	110	250	325	
	16-12	1		1												
18	18-1	10									10	70	145	215	290	
	18-23 ★	10									10				12	100
	18A31★	10									10				5	110
	18-24 ★	10									10				13	250
	18-3	2						2				35	110	250	325	
	18-25 ★	2						2							12	100
	18-4	4						4				35	110	250	325	
	18-5	3							2	1		80	110	250	280	
	18-27 ★	3								2	1				12	100
	18-6	1		1												
	18-7	1			1											
	18-8	8							1	7		70			290	
	18-9	7							2	5		80	110	250	280	
	18-17 ★	7								2	5				12	100
	18-10	4								4			120	240		
	18-11	5								5			170	265		
	18-12	6								6			80		280	
18-13	4			1	3						80	110	250	280		
18-19	10								10			120	240			
18-20	5								5		90	180	270			
18-21	3									3						
18-22	3									3	70	145	215	290		
20	20-2	1	1													
	20-3	3								3	70	145	215	290		
	20-4	4								4	45	110	250			
	20-5	2								2	35	110	250	325		
	20-6	3								3	70	145	215	290		
	20-7	8								8	80	110	250	280		
	20-32 ★	8								8					2	260
	20-8	6				2	4				80	110	250	280		
	20-9	8					1	7			80	110	250	280		

Special Position (★) - the basic normal insert configurations are same as the right above the column marked "★"

KDB / VG 95234 Series

Alternate Insert Positions

※View shows pin front side or socket rear side

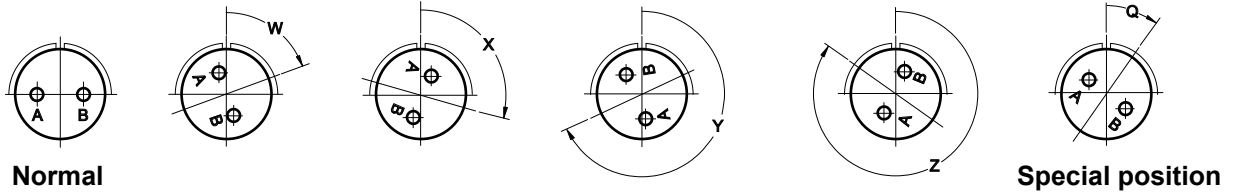

Shell size	Insert Number	Contacts						Alternate Pos.				Spec Pos.		
		Tot	0	4	8	12	16	20	W	X	Y	Z	No.	Q
20	20-11	13					13							
	20-25 ★	13					13						12	100
	20-30 ★	13					13						8	250
	20-14	5			2	3		80	110	250	280			
	20-15	7				7		80			280			
	20-16	9				2	7	80	110	250	280			
	20-17	6				5	1	90	180	270				
	20-18	9				3	6	35	110	250	325			
	20-19	3			3			90	180	270				
	20-22	6				3	3	80	110	250	280			
	20-23	2				2		35	110	250	325			
	20-24	4				2	2	35	110	250	325			
	20-27	14					14	35	110	250	325			
	20-29	17					17	80			280			
	20-31	11					11							
	20-33	11					11						3	110
	20-33	11					11						17	130
	20-33	11					11						2	260
	20A9	9					9			110	250			
	20A24	24						24						
20A48	19					19			80	280				
22	22-1	2			2			35	110	250	325			
	22-2	3			3			70	145	215	290			
	22-4	4			2	2		35	110	250	325			
	22-5	6				2	4	35	110	250	325			
	22-32 ★	6				2	4						2	260
	22-7	1	1											
	22-8	2				2		35	110	250	325			
	22-9	3				3		70	145	215	290			
	22-10	4					4	35	110	250	325			
	22-12	5				2	3	80	110	250	280			
	22-14	19					19	80	110	250	280			
	22-30 ★	19					19						2	260
	22-15	6					5	1	80	110	250	280		

Shell size	Insert Number	Contacts						Alternate Pos.				Spec Pos.		
		Tot	0	4	8	12	16	20	W	X	Y	Z	No.	Q
22	22-16	9				3	6		80	110	250	280		
	22-18	8					8	80	110	250	280			
	22-19	14					14	80	110	250	280			
	22-20	9					9	35	110	250	325			
	22-22	4				4			110	250				
	22-23	8				8		35		250				
	22-27	9				1	8	80		250	280			
	22-28	7					7	80			280			
	22-33	7					7	80	110	250	280			
	22-34	5				3	2	80	110	250	280			
	22-36	8					8	90		270				
	22B22	4					4			110	250			
	24	24-2	7				7		80			280		
		24-5	16					16	80	110	250	280		
24-6		8				8		80	110	250	280			
24-7		16				2	14	80	110	250	280			
24A35 ★		16				2	14						12	100
24-9		2				2		35	110	250	325			
24-10		7				7		80			280			
24-11		9				3	6	35	110	250	325			
24-12		5				2	3	80	110	250	280			
24-16		7				1	3	3	80	110	250	280		
24-20		11					2	9	80	110	250	280		
24-21		10					1	9	80	110	250	280		
24-22		4					4		45	110	250			
24-23		5					3	2	80	110	250	280		
24-27		7						7	80			280		
24-28		24						24	80	110	250	280		
24-80	23						23	35	145	240	300			
24B24	12						12					4	80	
24B24	12						12					12	100	
24B24	12						12					2	260	
24B24	12						12					9	280	
24A28	28						28	65	146	235				

Special Position (★) - the basic normal insert configurations are same as the right above the column marked "★"

KDB / VG 95234 Series

Alternate Insert Positions

※View shows pin front side or socket rear side

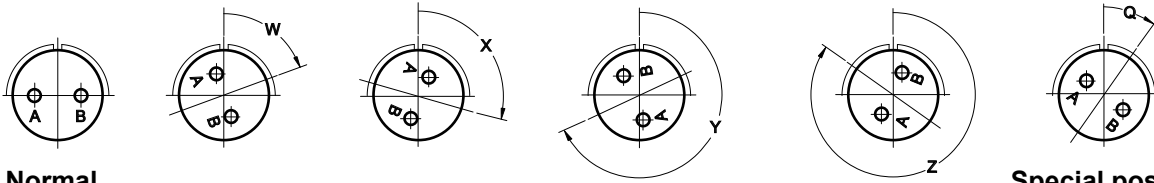

Normal

Special position

Shell size	Insert Number	Contacts						Alternate Pos.				Spec Pos.			
		Tot	0	4	8	12	16	20	W	X	Y	Z	No.	Q	
28	28-1	9			3	6			80	110	250	280			
	28-2	14				2	12		35	110	250	325			
	28-3	3			3				70	145	215	290			
	28-4	9				2	7		80	110	250	280			
	28-5	5		2		1	2		35	110	250	325			
	28-6	3		3					70	145	215	290			
	28-7	2		2					35	110	250	325			
	28-9	12				6	6		80	110	250	280			
	28-10	7		2	2	3			80	110	250	280			
	28-11	22				4	18		80	110	250	280			
	28-12	26					26		90	180	270				
	28-13 ★	26					26						12	100	
	28-14	11					11		80	110	250	280			
	28-15	35					35		80	110	250	280			
	28-16	20					20		80	110	250	280			
	28-17	15					15		80	110	250	280			
	28-19	10				4	6		80	110	250	280			
	28-20	14				10	4		80	110	250	280			
	28-21	37					37		80	110	250	280			
	28-22	6		3			3		70	145	215	290			
	28-51	12				12			80	135	195				
	28A16	9		4			5						3	110	
	28A16	9		4			5						8	250	
	28A16	9		4			5						2	260	
	28A16	9		4			5						9	280	
	28A51	43					43						4	80	
	28A51	43					43						12	100	
	28A51	43					43						3	110	
28A51	43					43						8	250		
28A51	43					43						9	280		
28A63	28				9	19			100	260					
32	32-1	5	2			3			80	110	250	280			
	32A30 ★	5	2			3							12	100	
	32-19 ★	5	2			3							2	260	
	32	32-2	5			3				70	145	215	290		
		32-3	9	1	2		2	4		80	110	250	280		
		32-4	14	14				2	12		80	110	250	280	
		32-5	2	2						35	110	250	325		
		32-6	23		2	3	2	16		80	110	250	280		
		32-20 ★	23		2	3	2	16						2	260
		32-7	35				7	28		80	125	235	280		
		32-8	30				6	24		80	125	235	280		
		32-9	14		2			12		80	110	250	280		
32-10		7		2	2		3		80	110	250	280			
32-12		15				5	10		80	110	250	280			
32-13		23				5	18		80	110	250	280			
32-14		7		2	5				35	110	250	325			
32-15		8	2			6			35	110	250	280			
32-17		4		4					45	110	250				
32-22		54					54		80	110	250	280			
32A10 ★	54					54						12	100		
32A10 ★	54					54						2	260		
32-63	5		5												
32-73	46					46		36							
32-101	101					101	30	142							
32A5	5		5					90	180	270					
32A47	47					47						4	80		
32A47	47					47						12	100		
32A47	47					47						3	110		
32A47	47					47						8	250		
32A47	47					47						2	260		
32A47	47					47						9	280		
32A55	55					55	80	110	250	280					
32A69	61					20	41	110	250						
36	36-1	22				4	18		80	110	250	280			
	36-2	5	3			2									
	36-3	6	3			3			70	145	215	290			
	36-4	3	3						70	145	215	290			

Special Position (★) - the basic normal insert configurations are the same as the right above the column marked "★"

KDB / VG 95234 Series

Contact Arrangements

Alternate Insert Positions

※ View shows pin front side or socket rear side

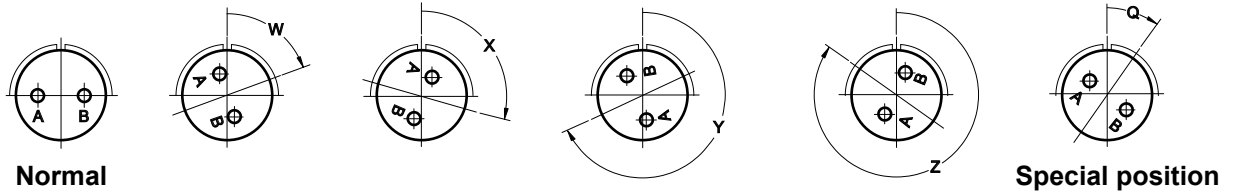

Shell size	Insert Number	Contacts								Alternate Pos.				Spec Pos.	
		Tot	0	4	8	12	16	20	W	X	Y	Z	No.	Q	
36	36-5	4	4							120	240				
	36-6	6	2	4					35	110	250	325			
	36-7	47				7	40		80	110	250	280			
	36-8	47					1	46		80	110	250	280		
	36-9	31		1	2	14	14			80	125	235	280		
	36-10	48						48		80	125	235	280		
	36-11★	48						48						12	100
	36-12★	48						48						13	250
	36-14	16				5	5	6		90	180	270			
	36-15	35						35		60	125	245	305		
	36-19	17	1	1			5	10		80	110	250	280		
	36-20	34				2	2	30							
	36-52	52						52		72	144	216	288		
	36-66	56					4	52		110	250	260	280		
	36-77	7		7											
	36-78	14				12		2		35	106	254	325		
	36A34	52						52						4	80
	36A34	52						52						12	100
	36A34	52						52						3	110
	36A34	52						52						20	220
	36A34	52						52						8	250
	36A34	52						52						2	260
	36A34	52						52						9	280
	36A35	8		4				4						3	110
	36A35	8		4				4						8	250
	36A35	8		4				4						2	260
	36A35	8		4				4						9	280
	36A46	27					27							4	80
	36A46	27					27							12	100
	36A46	27					27							3	110
	36A46	27					27							8	250
	36A46	27					27							2	260
	36A46	27					27							9	280
	36A99	65						15	50		30	145			

Special Insert Alternations

Special insert alternations are marked by positions Q. The position number indicates the turning of the contact insert in the direction of the polarizing key in view of the mating or termination side of the socket insulator.

Position No.	Position Q
2	260
3	110
4	80
5	110 use Pos. 3
6	85
8	250
9	280
11	105
12	100
13	250 use Pos. 8
14	30
15	45
16	120
17	130
18	150
19	195
20	220
21	255
22	290
23	165
24	330
25	235
26	125

Special Position (★) - the basic normal insert configurations are same as the right above the column marked "★"

KDB / VG 95234 Series

Contact Arrangements

CONTACT SIZE

20 ○ 16 ● 12 ⊕ 8 ⊕ 4 ⊕ 0 ⊕

1 CONTACTS



Insert number	12S-4	12-5	14-3	14S-4
No. of contacts	1	1	1	1
Contact size	16	12	8	16
Service rating	D	D	A	D

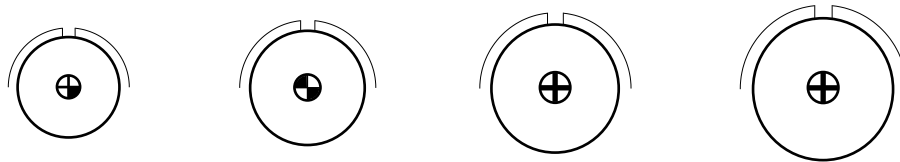

Insert number	16-12	18-7	20-2	22-7
No. of contacts	1	1	1	1
Contact size	4	8	0	0
Service rating	A	B	D	E

2 CONTACTS



Insert number	10SL-4	12S-3	14S-9	16S-4
No. of contacts	2	2	2	2
Contact size	16	16	16	16
Service rating	A	A	A	D

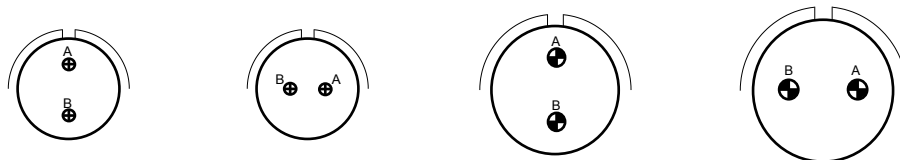

Insert number	16-11	18-3	20-23	22-1
No. of contacts	2	2	2	2
Contact size	12	12	8	8
Service rating	A	D	D	D

KDB / VG 95234 Series

CONTACT SIZE

20 ○ 16 ● 12 ⊕ 8 ⊕ 4 ⊕ 0 ⊕

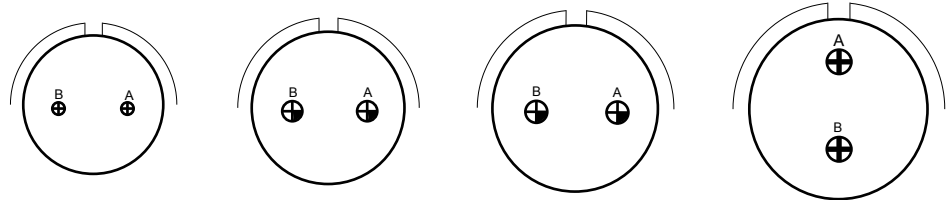

Insert number	22-8	24-9	28-7	32-5
No. of contacts	2	2	2	2
Contact size	12	4	4	0
Service rating	E	A	D	D

3 CONTACTS



Insert number	10SL-3	14S-1	14S-7	16S-5
No. of contacts	3	3	3	3
Contact size	16	16	16	16
Service rating	A	A	A	A



Insert number	16-7	16-10	18-5	18-21
No. of contacts	3	3	3	3
Contact size	2-16,1-8	12	1-16,2-12	12
Service rating	A	A	D	A

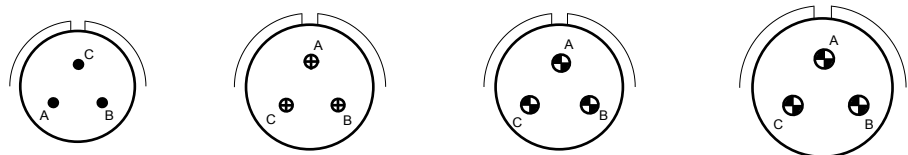

Insert number	18-22	20-3	20-19	22-2
No. of contacts	3	3	3	3
Contact size	16	12	8	8
Service rating	D	D	A	D

KDB / VG 95234 Series

CONTACT SIZE

20 ○ 16 ● 12 ⊕ 8 ⊕ 4 ⊕ 0 ⊕

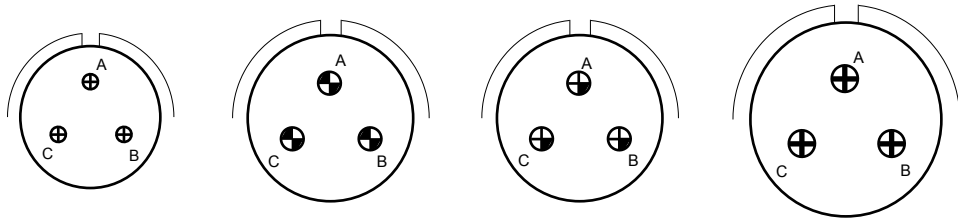

Insert number	22-9	28-3	28-6	36-4
No. of contacts	3	3	3	3
Contact size	12	8	4	0
Service rating	E	E	D	D(A) A(B,C)

4 CONTACTS



Insert number	12SA10	14S-2	16-9	18-4
No. of contacts	4	4	4	4
Contact size	16	16	2-16,2-12	16
Service rating	INST	INST	A	D



Insert number	18-10	18-13	20-4	20-24
No. of contacts	4	4	4	4
Contact size	12	3-12,1-8	12	2-16,2-8
Service rating	A	A	D	A

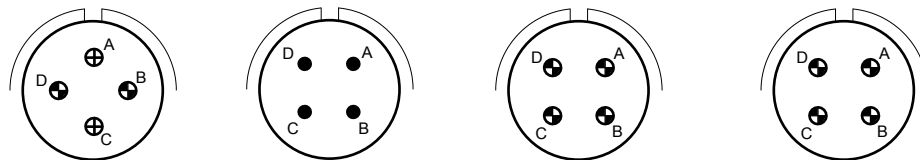

Insert number	22-4	22-10	22-22	22B22
No. of contacts	4	4	4	4
Contact size	2-12,2-8	16	8	8
Service rating	A	E	A	A

KDB / VG 95234 Series

CONTACT SIZE

20 ○ 16 ● 12 ⊕ 8 ⊕ 4 ⊕ 0 ⊕

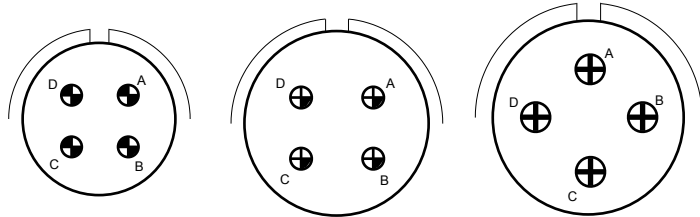

Insert number	24-22	32-17	36-5
No. of contacts	4	4	4
Contact size	8	4	0
Service rating	D	D	A

5 CONTACTS



Insert number	14S-5	16S-8	18-11	18-20
No. of contacts	5	5	5	5
Contact size	16	16	12	16
Service rating	INST	A	A	A

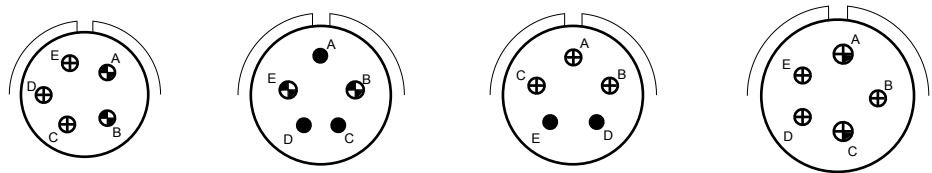

Insert number	20-14	22-12	22-34	24-12
No. of contacts	5	5	5	5
Contact size	3-12,2-8	3-16,2-8	2-16,3-12	3-12,2-4
Service rating	A	D	D	A

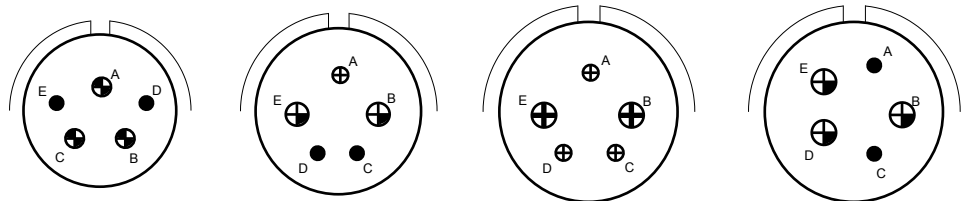

Insert number	24-23	28-5	32-1	32-2
No. of contacts	5	5	5	5
Contact size	2-16,3-8	2-16,1-12,2-4	3-12,2-0	2-16,3-4
Service rating	D	D	E(A) D(B,C,D,E)	E

KDB / VG 95234 Series

CONTACT SIZE

20 ○ 16 ● 12 ⊕ 8 ⊕ 4 ⊕ 0 ⊕

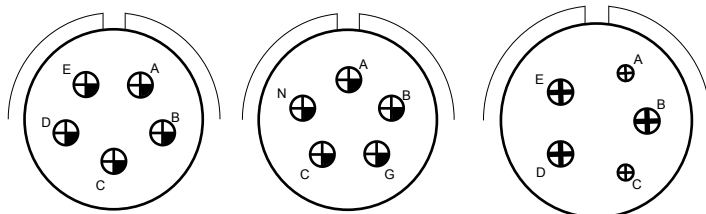

Insert number	32-63	32A5	36-2
No. of contacts	5	5	5
Contact size	4	4	2-12,3-0
Service rating	D	D	D

6 CONTACTS



Insert number	14S-6	18-12	20-8	20-17
No. of contacts	6	6	6	6
Contact size	16	16	4-16,2-8	1-16,5-12
Service rating	INST	A	INST	A

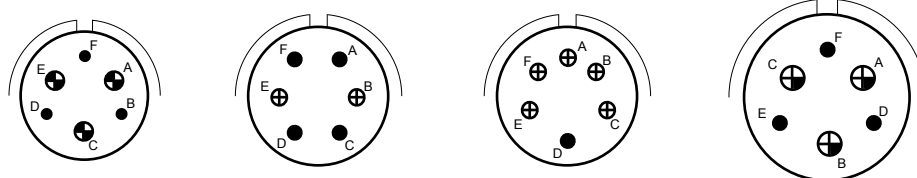

Insert number	20-22	22-5	22-15	28-22
No. of contacts	6	6	6	6
Contact size	3-16,3-8	4-16,2-12	1-16,5-12	3-16,3-4
Service rating	A	D	E(D) A(all others)	D

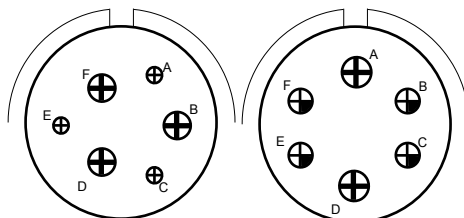

Insert number	36-3	36-6
No. of contacts	6	6
Contact size	3-12,3-0	4-4,2-0
Service rating	D	A

KDB / VG 95234 Series

CONTACT SIZE

20 ○ 16 ● 12 ⊕ 8 ⊕ 4 ⊕ 0 ⊕

7 CONTACTS

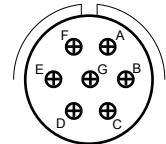
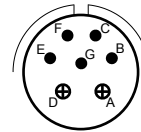
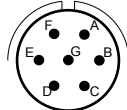
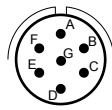

Insert number	14SA7	16S-1	18-9	20-15
No. of contacts	7	7	7	7
Contact size	16	16	5-16,2-12	12
Service rating	INST	A	INST	A

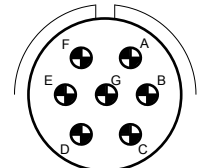
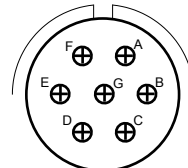
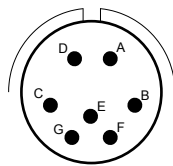
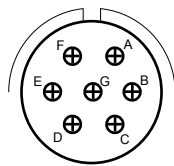

Insert number	22-28	22-33	24-2	24-10
No. of contacts	7	7	7	7
Contact size	12	16	12	8
Service rating	A	D(all others) A(E,F,G)	D	A

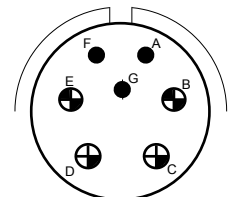
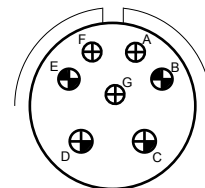
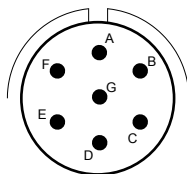
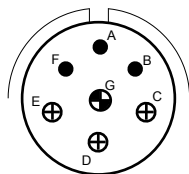

Insert number	24-16	24-27	28-10	32-10
No. of contacts	7	7	7	7
Contact size	3-16,3-12,1-8	16	3-12,2-8,2-4	3-16,2-8,2-4
Service rating	D(A,B,F,G) A(all others)	E	D(G) A(A,B,C,D,E,F)	B(G) E(A,F) D(B,E) A(C,D)

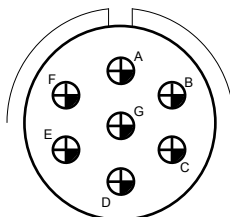
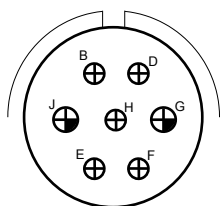

Insert number	32-14	36-77
No. of contacts	7	7
Contact size	5-12,2-4	4
Service rating	D	D

KDB / VG 95234 Series

CONTACT SIZE

20 ○ 16 ● 12 ⊕ 8 ⊕ 4 ⊕ 0 ⊕

8 CONTACTS

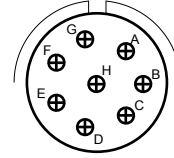
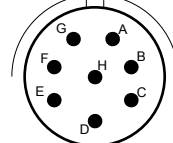
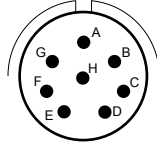
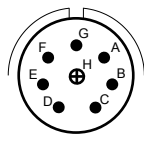

Insert number	18-8	20-7	22-18	22-23
No. of contacts	8	8	8	8
Contact size	7-16,1-12	16	16	12
Service rating	A	D(A,B,H,G) A(all others)	D(all others) A(C,D,E)	D(H) A(all others)

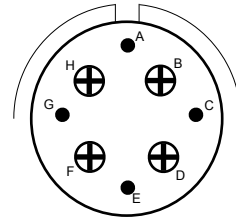
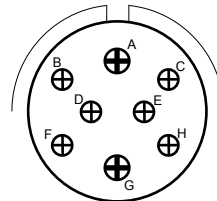
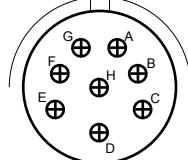
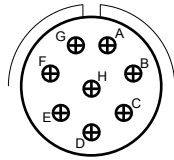

Insert number	22-36	24-6	32-15	36A35
No. of contacts	8	8	8	8
Contact size	12	12	6-12,2-0	4-16,4-0
Service rating	D(H) A(all others)	D(A,G,H) A(all others)	D	D

9 CONTACTS

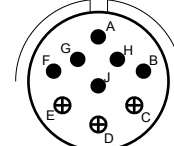
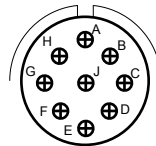
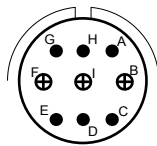
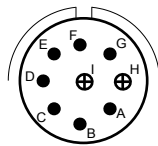

Insert number	20-16	20-18	20A9	22-16
No. of contacts	9	9	9	9
Contact size	7-16,2-12	6-16,3-12	12	6-16,3-12
Service rating	A	A	D(J) INST(all others)	A

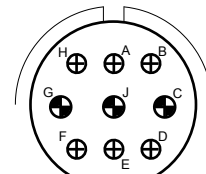
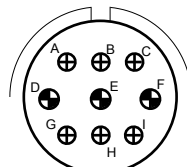
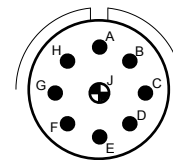
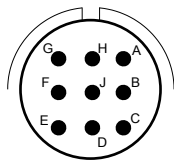

Insert number	22-20	22-27	24-11	28-1
No. of contacts	9	9	9	9
Contact size	16	8-16,1-8	6-12,3-8	6-12,3-8
Service rating	A	D(J) A(all others)	A	D(A,E,J) A(B,C,D,F,H,G)

KDB / VG 95234 Series

CONTACT SIZE

20 ○ 16 ● 12 ⊕ 8 ⊕ 4 ⊕ 0 ⊕

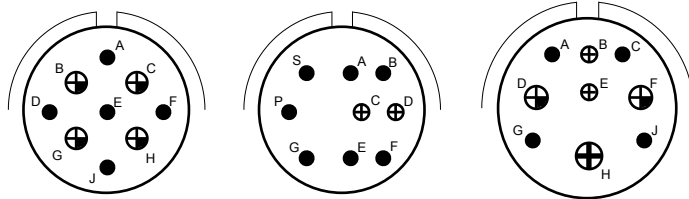

Insert number	28A16	28-4	32-3
No. of contacts	9	9	9
Contact size	5-16,4-4	7-16,2-12	4-16,2-12,2-4,1-0
Service rating	A(E) INST(all others)	E(G,P,S) D(A,B,C,D,E,F)	D

10 CONTACTS



Insert number	14SA10	18-1	18-19	24-21
No. of contacts	10	10	10	10
Contact size	20	16	16	9-16,1-8
Service rating	A	A(B,C,F,G) INST(all others)	A	D

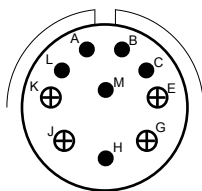

Insert number	28-19
No. of contacts	10
Contact size	6-16,4-12
Service rating	D(A,B) B(H,M) A(all others)

11 CONTACTS

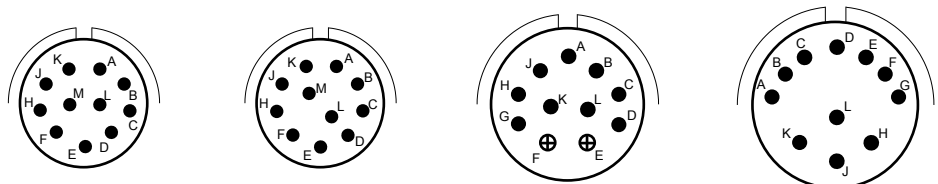

Insert number	20-31	20-33	24-20	28-14
No. of contacts	11	11	11	11
Contact size	16	16	9-16,2-12	16
Service rating	A	A	D	D

KDB / VG 95234 Series

CONTACT SIZE

20 ○ 16 ● 12 ⊕ 8 ⊕ 4 ⊕ 0 ⊕

12 CONTACTS

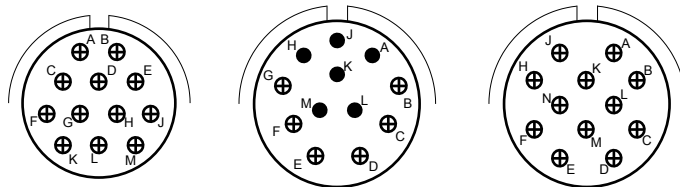

Insert number	24B24	28-9	28-51
No. of contacts	12	12	12
Contact size	12	6-16,6-12	12
Service rating	A	D	D

13 CONTACTS

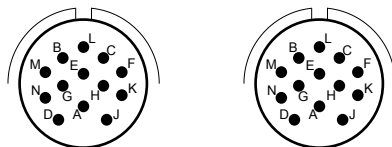

Insert number	20-11	20A16
No. of contacts	13	13
Contact size	16	16
Service rating	INST	INST

14 CONTACTS

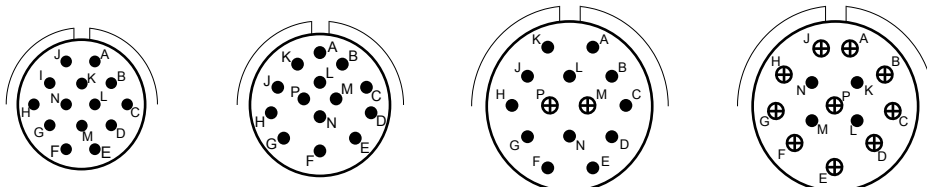

Insert number	20-27	22-19	28-2	28-20
No. of contacts	14	14	14	14
Contact size	16	16	12-16,2-12	4-16,10-12
Service rating	A	A	D	A

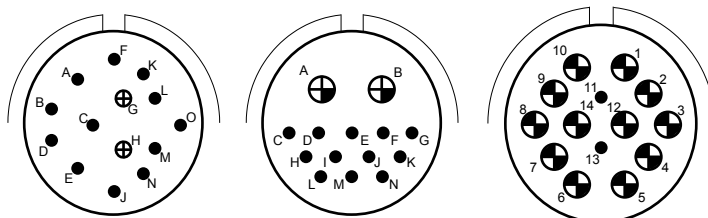

Insert number	32-4	32-9	36-78
No. of contacts	14	14	14
Contact size	12-16,2-12	12-16,2-4	2-16,12-8
Service rating	D(All others) A(F,J,K,N)	D	D

KDB / VG 95234 Series

CONTACT SIZE

20 ○ 16 ● 12 ⊕ 8 ⊕ 4 ⊕ 0 ⊕

15 CONTACTS

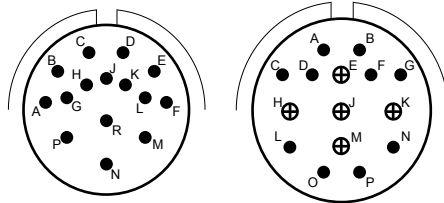

Insert number	28-17	32-12
No. of contacts	15	15
Contact size	16	10-16,5-12
Service rating	B(R), D(M,N,P) A(All others)	A(C,D,E,F,G) D(All others)

16 CONTACTS

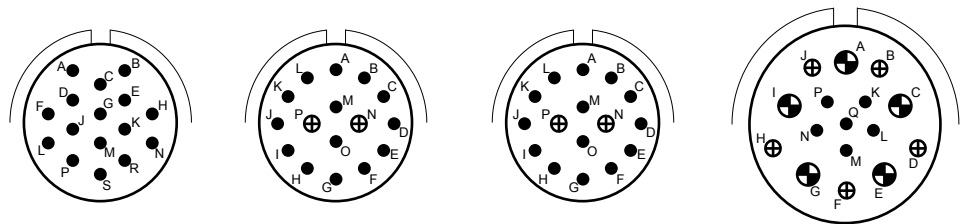

Insert number	24-5	24-7	24A35	36-14
No. of contacts	16	16	16	16
Contact size	16	14-16,2-12	14-16,2-12	6-16,5-12,5-8
Service rating	A	A	A	D

17 CONTACTS

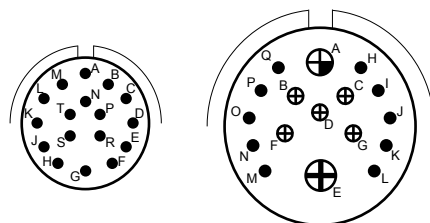

Insert number	20-29	36-19
No. of contacts	17	17
Contact size	16	10-16,5-12,1-4,1-0
Service rating	A	D

KDB / VG 95234 Series

CONTACT SIZE

20 ○ 16 ● 12 ⊕ 8 ⊕ 4 ⊕ 0 ⊕

19 CONTACTS

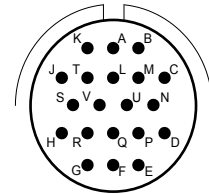
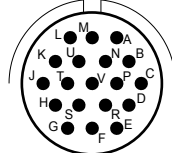
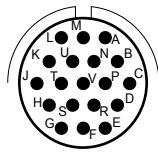

Insert number	20A48	22-14	28-16
No. of contacts	19	19	20
Contact size	16	16	16
Service rating	INST	A	A

20 CONTACTS

22 CONTACTS

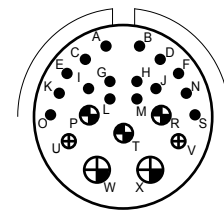
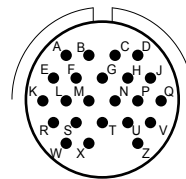
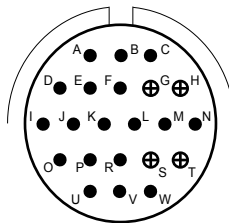
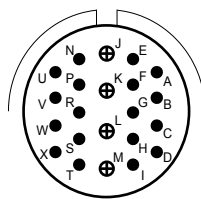

Insert number	28-11	36-1	24-80	32-6
No. of contacts	22	22	23	23
Contact size	18-16,4-12	18-16,4-12	16	16-16,2-12,3-8,2-4
Service rating	A	A	INST	A

23 CONTACTS

24 CONTACTS

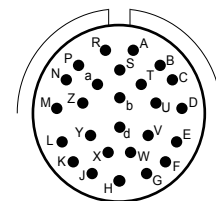
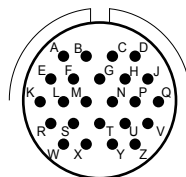
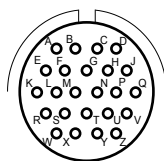

Insert number	20A24	24-28	28-12
No. of contacts	24	24	26
Contact size	20	16	16
Service rating	INST	INST	A

26 CONTACTS

KDB / VG 95234 Series

CONTACT SIZE

20 ○ 16 ● 12 ⊕ 8 ⊕ 4 ⊕ 0 ⊕

27 CONTACTS

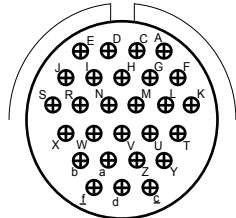

28 CONTACTS

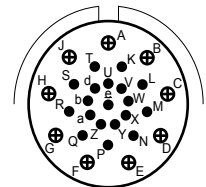
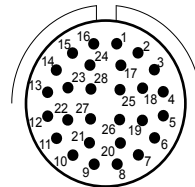

Contact arrangement	36A46	24A28	28A63
No. of contacts	27	28	28
Contact size	12	16	19-16,9-12
Service rating	A	INST	A

30 CONTACTS

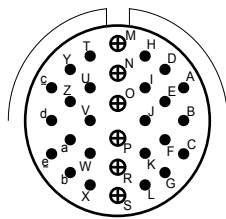

31 CONTACTS

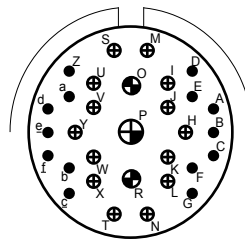

34 CONTACTS

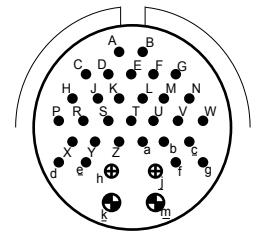

Contact arrangement	32-8	36-9	36-20
No. of contacts	30	31	34
Contact size	24-16,6-12	14-16,14-12,2-8,1-4	30-16,2-12,2-8
Service rating	A	A	A

35 CONTACTS

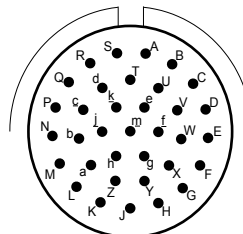
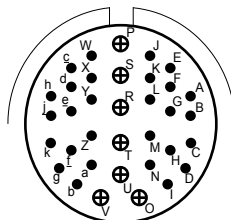
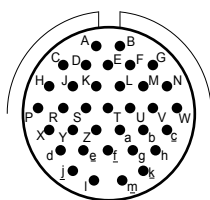

Contact arrangement	28-15	32-7	36-15
No. of contacts	35	35	35
Contact size	16	28-16,7-12	16
Service rating	A	A(All others) INST(A,B,h,j)	D(m) A(All others)

KDB / VG 95234 Series

CONTACT SIZE

20 ○ 16 ● 12 ⊕ 8 ⊕ 4 ⊕ 0 ⊕

37 CONTACTS

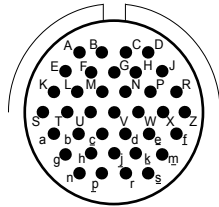

43 CONTACTS

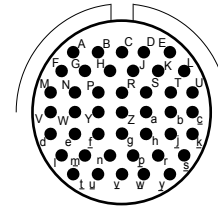
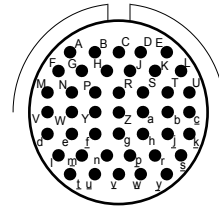

Insert number	28-21	28A51	28B51
No. of contacts	37	43	43
Contact size	16	16	16
Service rating	A	A	A

46 CONTACTS

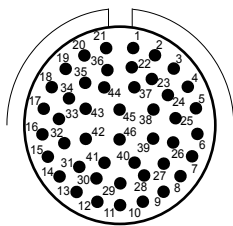

47 CONTACTS

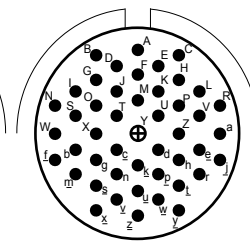
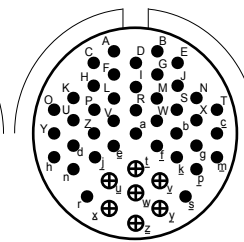
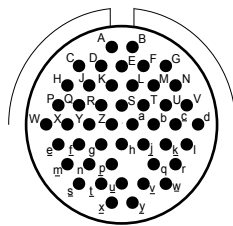

Insert number	32-73	32A47	36-7	36-8
No. of contacts	46	47	47	47
Contact size	16	16	40-16,7-12	46-16,1-12
Service rating	A	A	A	A

48 CONTACTS

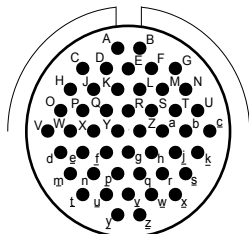

52 CONTACTS

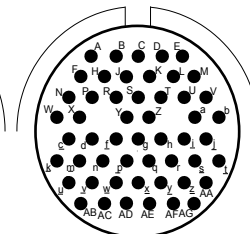
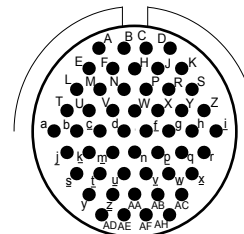

Insert number	36-10	36-52	36A34
No. of contacts	48	52	52
Contact size	16	16	16
Service rating	A	A	A

KDB / VG 95234 Series

CONTACT SIZE

20 ○ 16 ● 12 ⊕ 8 ⊕ 4 ⊕ 0 ⊕

54 CONTACTS

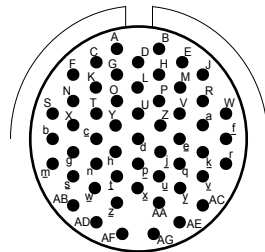

55 CONTACTS

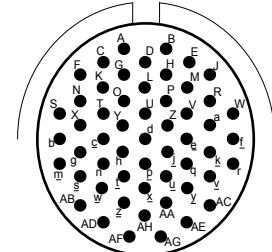

Insert number	32-22	32A55
No. of contacts	54	55
Contact size	16	16
Service rating	A	A

56 CONTACTS

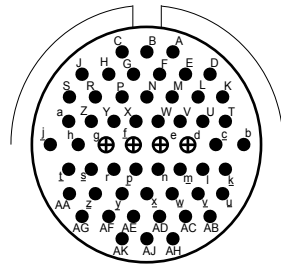

61 CONTACTS

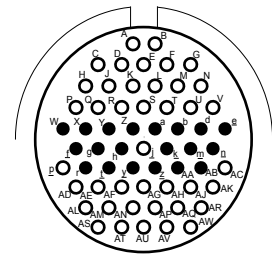

Insert number	36-66	32A69
No. of contacts	56	55
Contact size	52-16,4-12	41-20,20-16
Service rating	A	INST

65 CONTACTS

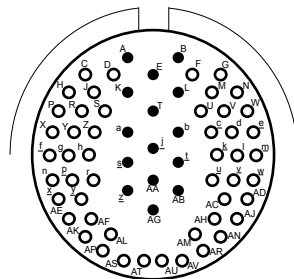

101 CONTACTS

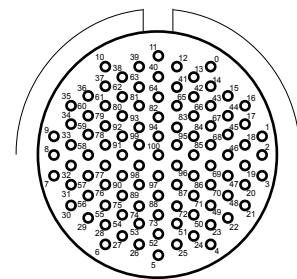

Insert number	36A99	32-101
No. of contacts	65	101
Contact size	50-20,15-16	20
Service rating	INST	A

KDB / VG 95234 Series

Connector Dimensions

KDB 00EP-TLxx

Wall mounting receptacle shielded with Tinel - Lock adapter

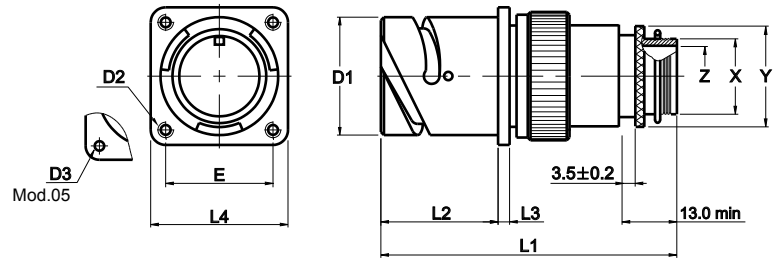

KDB order No.	Shell size	∅D1 -0.15	∅D2	∅D3 Mod.05	E ±0.1	L1 max	L2 +0.4	L3 ±0.2	L4 ±0.3	Entry max
KDB 00EP 10SL-xx-xx-TLxx	10SL	18.20	M4	3.2	18.2	55	18.2	2.8	25.4	05
KDB 00EP 12S -xx-xx-TLxx	12S	21.40	M4	3.2	20.6	55	18.2	3.2	28.0	06
KDB 00EP 14S -xx-xx-TLxx	14S	24.60	M4	3.2	23.0	60	18.2	3.2	30.0	07
KDB 00EP 16S -xx-xx-TLxx	16S	27.40	M4	3.2	24.6	75	18.2	3.2	32.5	08
KDB 00EP 16 -xx-xx-TLxx	16	27.40	M4	3.2	24.6	75	21.5	3.2	32.5	08
KDB 00EP 18 -xx-xx-TLxx	18	30.80	M4	3.2	27.0	80	23.1	4.0	35.0	10
KDB 00EP 20 -xx-xx-TLxx	20	34.20	M4	3.2	29.4	80	23.1	4.0	38.0	12
KDB 00EP 22 -xx-xx-TLxx	22	37.40	M4	3.2	31.8	85	23.1	4.0	41.0	14
KDB 00EP 24 -xx-xx-TLxx	24	40.90	M4	3.7	34.9	85	23.1	4.0	44.5	16
KDB 00EP 28 -xx-xx-TLxx	28	46.70	M5	3.7	39.7	85	24.1	4.0	50.8	18
KDB 00EP 32 -xx-xx-TLxx	32	53.40	M5	4.3	44.5	90	24.1	4.0	57.0	22
KDB 00EP 36 -xx-xx-TLxx	36	59.60	M5	4.3	49.2	90	24.1	4.0	63.5	24

KDB 00EP-ZLxx

Wall mounting receptacle shielded with Zetalok adapter

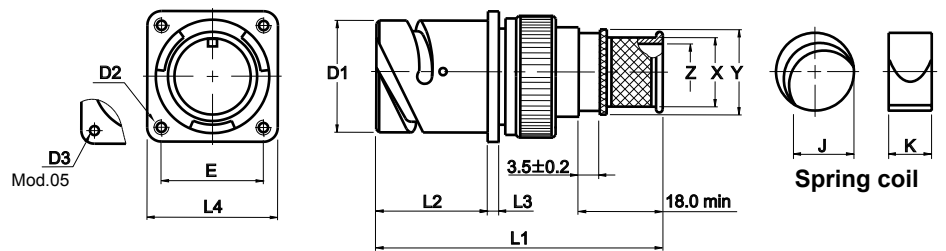

KDB order No.	Shell size	∅D1 -0.15	∅D2	∅D3 Mod.05	E ±0.1	L1 max	L2 +0.4	L3 ±0.2	L4 ±0.3	Entry max
KDB 00EP 10SL-xx-xx-ZLxx	10SL	18.20	M4	3.2	18.2	61	18.2	2.8	25.4	05
KDB 00EP 12S -xx-xx-ZLxx	12S	21.40	M4	3.2	20.6	64	18.2	3.2	28.0	06
KDB 00EP 14S -xx-xx-ZLxx	14S	24.60	M4	3.2	23.0	67	18.2	3.2	30.0	07
KDB 00EP 16S -xx-xx-ZLxx	16S	27.40	M4	3.2	24.6	75	18.2	3.2	32.5	08
KDB 00EP 16 -xx-xx-ZLxx	16	27.40	M4	3.2	24.6	80	21.5	3.2	32.5	08
KDB 00EP 18 -xx-xx-ZLxx	18	30.80	M4	3.2	27.0	85	23.1	4.0	35.0	10
KDB 00EP 20 -xx-xx-ZLxx	20	34.20	M4	3.2	29.4	85	23.1	4.0	38.0	12
KDB 00EP 22 -xx-xx-ZLxx	22	37.40	M4	3.2	31.8	90	23.1	4.0	41.0	14
KDB 00EP 24 -xx-xx-ZLxx	24	40.90	M4	3.7	34.9	90	23.1	4.0	44.5	16
KDB 00EP 28 -xx-xx-ZLxx	28	46.70	M5	3.7	39.7	90	24.1	4.0	50.8	18
KDB 00EP 32 -xx-xx-ZLxx	32	53.40	M5	4.3	44.5	95	24.1	4.0	57.0	22
KDB 00EP 36 -xx-xx-LZxx	36	59.60	M5	4.3	49.2	95	24.1	4.0	63.5	24

*Refer to TLxx-table I / ZLxx-table II, III page No. 29 for entry dimension.

*If you have any questioning on adapter angle 45°, 90° please as ask to our kukdong company.

KDB / VG 95234 Series

KDB 06EW-TLxx

Straight plug shielded with Tinel - Lock adapter

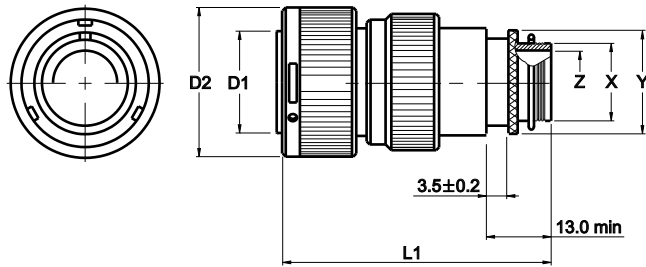

KDB order No.	Shell size	∅ D1 -0.3	∅ D2 max	L1 max	Entry max
KDB 06EW 10SL-xx-xx-TLxx	10SL	11.3	22.8	55	05
KDB 06EW 12S -xx-xx-TLxx	12S	14.0	26.0	55	06
KDB 06EW 14S -xx-xx-TLxx	14S	17.1	29.2	60	07
KDB 06EW 16S -xx-xx-TLxx	16S	20.4	32.0	70	08
KDB 06EW 16 -xx-xx-TLxx	16	20.4	32.0	70	08
KDB 06EW 18 -xx-xx-TLxx	18	23.6	36.5	75	10
KDB 06EW 20 -xx-xx-TLxx	20	26.7	39.9	75	12
KDB 06EW 22 -xx-xx-TLxx	22	29.8	43.1	80	14
KDB 06EW 24 -xx-xx-TLxx	24	33.0	46.6	80	16
KDB 06EW 28 -xx-xx-TLxx	28	38.6	53.4	85	18
KDB 06EW 32 -xx-xx-TLxx	32	44.9	60.1	90	22
KDB 06EW 36 -xx-xx-TLxx	36	50.3	66.3	90	24

KDB 06EW-ZLxx

Straight plug shielded with Zetalok adapter

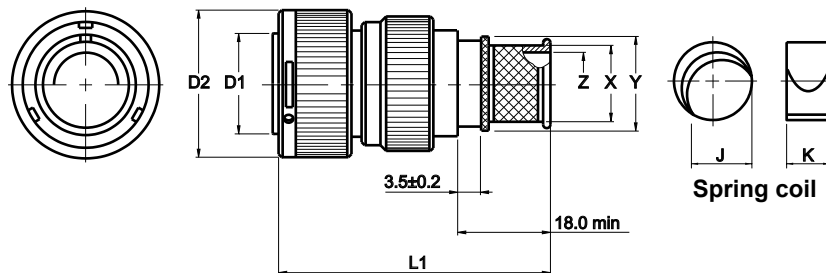

KDB order no	Shell size	∅ D1 -0.3	∅ D2 max	L1 max	Entry max
KDB 06EW 10SL- xx-xx-ZLxx	10SL	11.3	22.8	60	05
KDB 06EW 12S - xx-xx-ZLxx	12S	14.0	26.0	60	06
KDB 06EW 14S - xx-xx-ZLxx	14S	17.1	29.2	65	07
KDB 06EW 16S - xx-xx-ZLxx	16S	20.4	32.0	75	08
KDB 06EW 16 - xx-xx-ZLxx	16	20.4	32.0	75	08
KDB 06EW 18 - xx-xx-ZLxx	18	23.6	36.5	80	10
KDB 06EW 20 - xx-xx-ZLxx	20	26.7	39.9	80	12
KDB 06EW 22 - xx-xx-ZLxx	22	29.8	43.1	85	14
KDB 06EW 24 - xx-xx-ZLxx	24	33.0	46.6	85	16
KDB 06EW 28 - xx-xx-ZLxx	28	38.6	53.4	90	18
KDB 06EW 32 - xx-xx-ZLxx	32	44.9	60.1	95	22
KDB 06EW 36 - xx-xx-ZLxx	36	50.3	66.3	95	24

*Refer to TLxx-table I / ZLxx-table II, III page No. 29 for entry dimension.

*If you have any guesting on adapter angle 45°, 90° please as ask to our kukdong company.

KDB / VG 95234 Series

Entry Dimensions

TABLE I			
Entry Size	Z +0.1	X DIA	Y ±0.1
04	6.3	9.5	14.0
05	7.9	11.1	15.6
06	9.5	12.7	17.2
07	11.1	14.3	18.8
08	12.7	15.9	20.3
10	15.9	19.0	23.5
12	19.0	22.2	26.7
14	22.2	25.4	29.8
16	25.4	28.5	33.0
18	28.5	31.7	36.2
20	31.7	34.9	39.3
22	34.9	38.1	42.5
24	38.1	41.3	45.7

TABLE II				
Entry Size	Z +0.1	X -0.4	Y ±0.1	Spring Ref
03	4.7	7.8	14.0	HE 050
04	6.3	9.4	14.0	HE 050
05	7.9	11.0	15.6	HE 100
06	9.5	12.6	17.2	HE 100
07	11.1	14.2	18.8	HE 100
08	12.7	15.8	20.3	HE 200
09	14.3	17.4	21.9	HE 200
10	15.9	18.9	23.5	HE 200
11	17.5	20.5	25.1	HE 200
12	19.0	22.1	26.7	HE 300
13	20.6	23.7	28.3	HE 300
14	22.2	25.3	29.8	HE 300
15	23.8	26.9	31.4	HE 300
16	25.4	28.4	33.0	HE 300
17	27.0	30.0	34.6	HE 400
18	28.5	31.6	36.2	HE 400
19	30.1	33.2	37.8	HE 400
20	31.7	34.8	39.3	HE 400
21	33.3	36.4	40.9	HE 400
22	34.9	38.0	42.5	HE 400
23	36.5	39.6	44.1	HE 400
24	38.1	41.2	45.7	HE 400

TABLE III		
Spring Ref	J	K
HE 050	7.34	9.52
HE 100	9.22	9.52
HE 200	14.50	9.52
HE 300	18.50	9.52
HE 400	25.00	9.52

KDB / VG 95234 Series

KDB 00E / -F80 VG 95234 Style J1 KDB 00E / -05-F80 VG 95234 Style J2

Wall mounting receptacle with cable clamp and telescoping bushing

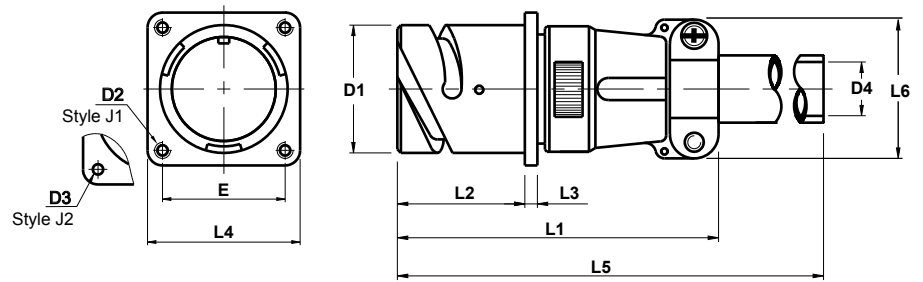

Shell size	∅D1 -0.15	D2 only J1	∅D3 only J2	∅D4 max	E ±0.1	L1 max	L2 +0.4	L3 ±0.2	L4 ±0.3	L5 max	L6 max
10SL	18.20	M4	3.2	5.6	18.2	60	18.2	2.8	25.4	120	22.7
12S	21.40	M4	3.2	5.6	20.6	60	18.2	3.2	28.0	120	22.7
14S	24.60	M4	3.2	8.0	23.0	62	18.2	3.2	30.0	120	27.5
16S	27.40	M4	3.2	11.1	24.6	70	18.2	3.2	32.5	120	30.0
16	27.40	M4	3.2	11.1	24.6	70	21.5	3.2	32.5	125	30.0
18	30.80	M4	3.2	14.3	27.0	77	23.1	4.0	35.0	125	33.0
20	34.20	M4	3.2	15.9	29.4	77	23.1	4.0	38.0	125	37.5
22	37.40	M4	3.2	15.9	31.8	77	23.1	4.0	41.0	125	37.5
24	40.90	M4	3.7	19.1	34.9	85	23.1	4.0	44.5	125	43.3
28	46.70	M5	3.7	19.1	39.7	85	24.1	4.0	50.8	125	43.3
32	53.40	M5	4.3	23.8	44.5	85	24.1	4.0	57.0	125	51.7
36	59.60	M5	4.3	31.8	49.2	105	24.1	4.0	63.5	135	58.0

KDB 00E / -15 VG 95234 Style N1 KDB 00E / -05-15 VG 95234 Style N2

shielded receptacle with endbell for shielded braids, and also for heat shrinkable boots

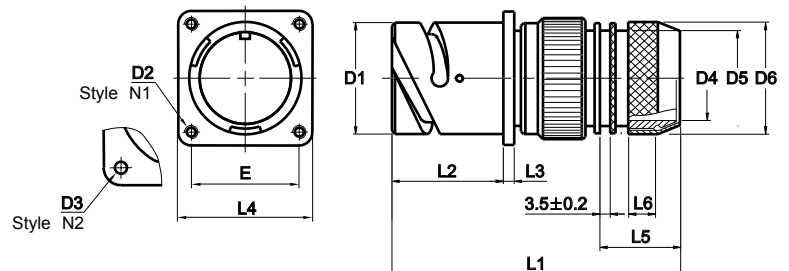

Shell size	∅D1 -0.15	D2 only N1	∅D3 only N2	∅D4 max	∅D5 max	∅D6 +0.5	E ±0.1	L1 max	L2 +0.4	L3 ±0.2	L4 ±0.3	L5 +1.0	L6 ±0.5
10SL	18.20	M4	3.2	7.7	16.3	18.5	18.2	55	18.2	2.8	25.4	17.0	7.0
12S	21.40	M4	3.2	9.3	17.0	20.0	20.6	55	18.2	3.2	28.0	17.0	7.0
14S	24.60	M4	3.2	10.6	20.0	22.0	23.0	55	18.2	3.2	30.0	17.0	7.0
16S	27.40	M4	3.2	13.5	23.0	25.0	24.6	70	18.2	3.2	32.5	18.0	8.0
16	27.40	M4	3.2	13.5	23.0	25.0	24.6	70	21.5	3.2	32.5	18.0	8.0
18	30.80	M4	3.2	14.6	24.5	28.0	27.0	70	23.1	4.0	35.0	18.0	8.0
20	34.20	M4	3.2	18.5	28.5	32.0	29.4	70	23.1	4.0	38.0	18.0	10.0
22	37.40	M4	3.2	20.8	30.5	34.0	31.8	70	23.1	4.0	41.0	18.0	10.0
24	40.90	M4	3.7	24.6	34.5	38.0	34.9	70	23.1	4.0	44.5	18.0	10.0
28	46.70	M5	3.7	27.0	37.5	41.0	39.7	70	24.1	4.0	50.8	18.0	10.0
32	53.40	M5	4.3	33.3	44.0	48.0	44.5	75	24.1	4.0	57.0	18.0	10.0
36	59.60	M5	4.3	38.5	51.0	55.0	49.2	85	24.1	4.0	63.5	18.0	10.0

KDB / VG 95234 Series

KDB 00E / -02 VG 95234 Style U1 KDB 00E / -02-05 VG 95234 Style U2

Wall mounting receptacle
with adapter for heat
shrinkable boots

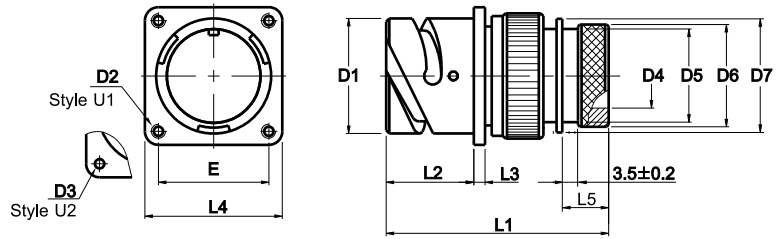

Shell size	∅D1 -0.15	D2 only U1	∅D3 only U2	∅D4	∅D5 max	∅D6 ±0.2	∅D7 ±0.2	E ±0.1	L1 max	L2 +0.4	L3 ±0.2	L4 ±0.3	L5 ±0.5
10SL	18.20	M4	3.2	7.7	13.3	15.5	17.0	18.2	57	18.2	2.8	25.4	11.7
12S	21.40	M4	3.2	7.9	13.3	15.5	17.8	20.6	57	18.2	3.2	28.0	11.7
14S	24.60	M4	3.2	10.6	17.0	19.1	20.1	23.0	57	18.2	3.2	30.0	11.7
16S	27.40	M4	3.2	13.5	21.9	23.9	23.5	24.6	57	18.2	3.2	32.5	11.7
16	27.40	M4	3.2	13.5	21.9	23.9	23.5	24.6	63	21.5	3.2	32.5	11.7
18	30.80	M4	3.2	14.6	21.9	23.9	26.5	27.0	65	23.1	4.0	35.0	11.7
20	34.20	M4	3.2	18.7	26.2	29.6	30.2	29.4	68	23.1	4.0	38.0	12.7
22	37.40	M4	3.2	20.8	26.2	29.6	33.6	31.8	68	23.1	4.0	41.0	12.7
24	40.90	M4	3.7	24.6	34.5	37.8	38.1	34.9	70	23.1	4.0	44.5	12.7
28	46.70	M5	3.7	27.0	34.5	37.8	41.4	39.7	71	24.1	4.0	50.8	12.7
32	53.40	M5	4.3	33.3	43.6	47.8	48.6	44.5	74	24.1	4.0	57.0	15.2
36	59.60	M5	4.3	38.5	43.6	47.8	54.8	49.2	74	24.1	4.0	63.5	15.2

KDB 00E / -08 KDB 00E / -09

Wall mounting receptacle
90° angle type with cable clamp
and bushing

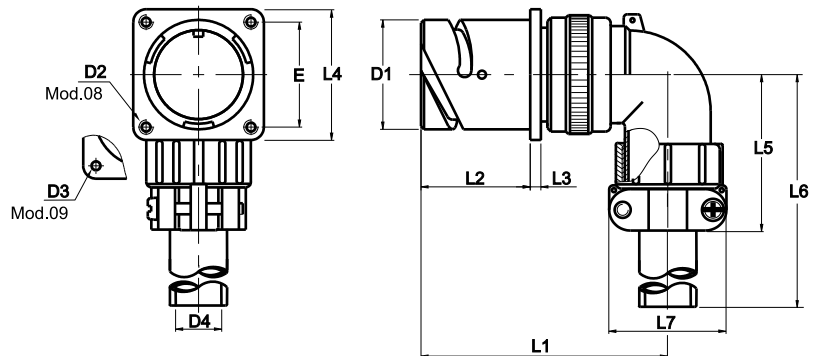

Shell size	∅D1 -0.15	D2 Mod.08	∅D3 Mod.09	∅D4 max	E ±0.1	L1 max	L2 +0.4	L3 ±0.2	L4 ±0.3	L5 max	L6 max	L7 max
10SL	18.20	M4	3.2	5.6	18.2	50	18.2	2.8	25.4	42	100	22.7
12S	21.40	M4	3.2	5.6	20.6	50	18.2	3.2	28.0	42	100	22.7
14S	24.60	M4	3.2	8.0	23.0	52	18.2	3.2	30.0	42	100	27.5
16S	27.40	M4	3.2	11.1	24.6	53	18.2	3.2	32.5	45	100	30.0
16	27.40	M4	3.2	11.1	24.6	60	21.5	3.2	32.5	45	100	30.0
18	30.80	M4	3.2	14.3	27.0	62	23.1	4.0	35.0	53	100	33.0
20	34.20	M4	3.2	15.9	29.4	66	23.1	4.0	38.0	53	100	37.5
22	37.40	M4	3.2	15.9	31.8	66	23.1	4.0	41.0	53	100	37.5
24	40.90	M4	3.7	19.1	34.9	69	23.1	4.0	44.5	58	100	43.3
28	46.70	M5	3.7	19.1	39.7	70	24.1	4.0	50.8	58	100	43.3
32	53.40	M5	4.3	23.8	44.5	74	24.1	4.0	57.0	66	110	51.7
36	59.60	M5	4.3	31.8	49.2	78	24.1	4.0	63.5	69	110	58.0

KDB / VG 95234 Series

KDB 02E / -F80 VG 95234 Style A

Box mounting receptacle
for front panel mounting

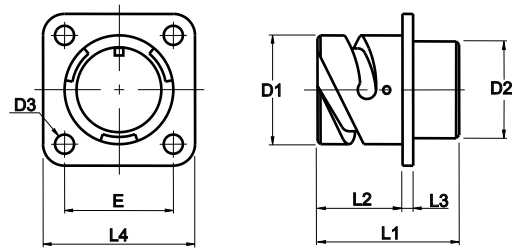

Shell size	∅D1 -0.15	∅D2 max	∅D3	E ±0.1	L1 ±0.3	L2 +0.4	L3 ±0.2	L4 ±0.3
10SL	18.20	16.2	3.2	18.2	24.7	14.2	2.8	25.4
12S	21.40	16.2	3.2	20.6	24.7	14.2	3.2	28.0
14S	24.60	19.2	3.2	23.0	24.7	14.2	3.2	30.0
16S	27.40	22.4	3.2	24.6	24.7	14.2	3.2	32.5
16	27.40	22.4	3.2	24.6	33.8	19.0	3.2	32.5
18	30.80	25.6	3.2	27.0	33.8	19.0	4.0	35.0
20	34.20	29.0	3.2	29.4	33.8	19.0	4.0	38.0
22	37.40	32.2	3.2	31.8	33.8	19.0	4.0	41.0
24	40.90	35.3	3.7	34.9	33.8	20.6	4.0	44.5
28	46.70	41.4	3.7	39.7	33.8	20.6	4.0	50.8
32	53.40	47.8	4.3	44.5	33.8	22.2	4.0	57.0
36	59.60	54.1	4.3	49.2	33.8	22.2	4.0	63.5

KDB 020E

Will mounting receptacle for rear
panel single hole mounting
threaded rear for accessories

KDB 020G

Same as KDB020E except :
RFI/EMI shielded coil within
receptacle shell threaded
rear for accessories

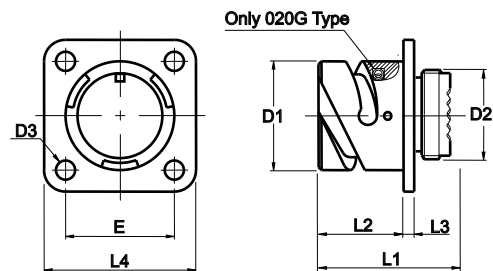

Shell size	∅D1 -0.15	Thread -2A	∅D3	E ±0.1	L1 ±0.3	L2 +0.4	L3 ±0.2	L4 ±0.3
10SL	18.20	9/16-24UNEF	3.2	18.2	24.7	14.2	2.8	25.4
12S	21.40	5/8-24UNEF	3.2	20.6	24.7	14.2	3.2	28.0
14S	24.60	3/4-20UNEF	3.2	23.0	24.7	14.2	3.2	30.0
16S	27.40	7/8-20UNEF	3.2	24.6	24.7	14.2	3.2	32.5
16	27.40	7/8-20UNEF	3.2	24.6	33.8	19.0	3.2	32.5
18	30.80	1 -20UNEF	3.2	27.0	33.8	19.0	4.0	35.0
20	34.20	1 1/8-18UNEF	3.2	29.4	33.8	19.0	4.0	38.0
22	37.40	1 1/4-18UNEF	3.2	31.8	33.8	19.0	4.0	41.0
24	40.90	1 3/8-18UNEF	3.7	34.9	33.8	20.6	4.0	44.5
28	46.70	1 5/8-18UNEF	3.7	39.7	33.8	20.6	4.0	50.8
32	53.40	1 7/8-16UN	4.3	44.5	33.8	22.2	4.0	57.0
36	59.60	2 1/8-16UN	4.3	49.2	33.8	22.2	4.0	63.5

KDB / VG 95234 Series

KDB 02E / -109
VG 95234 Style B1

KDB 02E / -05-F80
VG 95234 Style B2

Box mounting receptacle
 for rear panel mounting

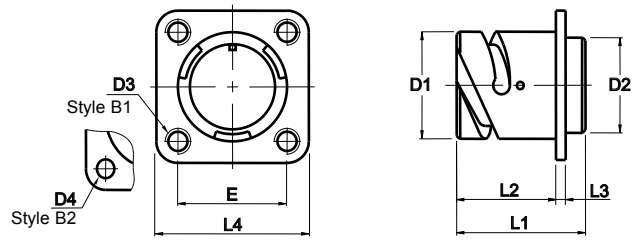

Shell size	∅D1 -0.15	∅D2 max	D3 only B1	∅D4 only B2	E ±0.1	L1 ±0.3	L2 +0.4	L3 ±0.2	L4 ±0.3
10SL	18.20	16.2	M4	3.2	18.2	24.7	18.2	2.8	25.4
12S	21.40	16.2	M4	3.2	20.6	24.7	18.2	3.2	28.0
14S	24.60	19.2	M4	3.2	23.0	24.7	18.2	3.2	30.0
16S	27.40	22.4	M4	3.2	24.6	24.7	18.2	3.2	32.5
16	27.40	22.4	M4	3.2	24.6	33.8	21.5	3.2	32.5
18	30.80	25.6	M4	3.2	27.0	33.8	23.1	4.0	35.0
20	34.20	29.0	M4	3.2	29.4	33.8	23.1	4.0	38.0
22	37.40	32.2	M4	3.2	31.8	33.8	23.1	4.0	41.0
24	40.90	35.3	M4	3.7	34.9	33.8	23.1	4.0	44.5
28	46.70	41.4	M5	3.7	39.7	33.8	24.1	4.0	50.8
32	53.40	47.8	M5	4.3	44.5	33.8	24.1	4.0	57.0
36	59.60	54.1	M5	4.3	49.2	33.8	24.1	4.0	63.5

KDB TB
VG 95234 Style C1

KDB TB / -05
VG 95234 Style C2

Thru-bulkhead receptacle

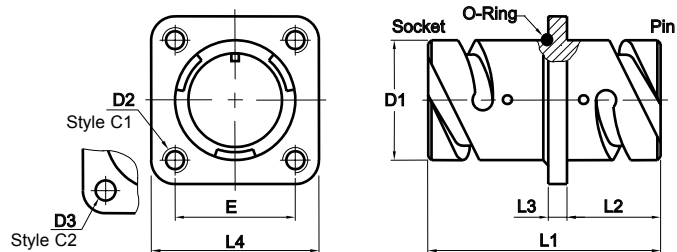

Shell size	∅D1 -0.15	D2 Only C1	∅D3 Only C2	E ±0.1	L1 ±0.7	L2 +0.4	L3 ±0.2	L4 ±0.3
10SL	18.20	M4	3.2	18.2	37.5	14.2	2.8	25.4
12S	21.40	M4	3.2	20.6	37.5	14.2	3.2	28.0
14S	24.60	M4	3.2	23.0	37.5	14.2	3.2	30.0
16S	27.40	M4	3.2	24.6	37.5	14.2	3.2	32.5
16	27.40	M4	3.2	24.6	51.4	19.0	3.2	32.5
18	30.80	M4	3.2	27.0	51.4	19.0	4.0	35.0
20	34.20	M4	3.2	29.4	51.4	19.0	4.0	38.0
22	37.40	M4	3.2	31.8	51.4	19.0	4.0	41.0
24	40.90	M4	3.7	34.9	51.4	20.6	4.0	44.5
28	46.70	M5	3.7	39.7	51.4	20.6	4.0	50.8
32	53.40	M5	4.3	44.5	51.4	22.2	4.0	57.0
36	59.60	M5	4.3	49.2	51.4	22.2	4.0	63.5

KDB / VG 95234 Series

KDB 07A

Jam nut receptacle for rear panel single hole mounting
panel seal o-ring included

KDB 07G

Same as KDB 07A except :
RFI/EMI shielded coil within receptacle shell

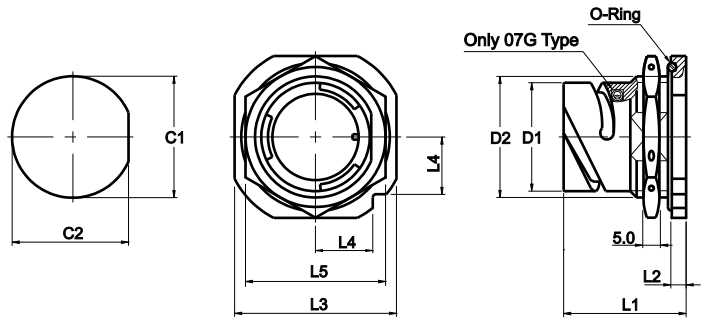

Shell size	∅D1 -0.15	D2 Thread -2A	L1 max	L2 ±0.1	L3 ±0.4	L4 ±0.1	L5 ±0.4	C1 +0.1	C2 +0.1
10SL	18.20	7/8-20UNEF	28.5	4.0	31.8	11.2	27.0	22.4	20.7
12S	21.40	1 -20UNEF	31.6	4.8	34.9	13.4	30.2	25.6	23.9
14S	24.60	1 1/8-18UNEF	31.6	4.8	41.3	14.6	33.0	28.8	27.1
16S	27.40	1 1/4-18UNEF	31.6	4.8	44.4	15.7	38.1	32.0	30.1
16	27.40	1 1/4-18UNEF	36.9	4.8	44.4	15.7	38.1	32.0	30.1
18	30.80	1 3/8-18UNEF	36.9	4.8	47.6	16.8	39.7	35.1	33.4
20	34.20	1 1/2-18UNEF	38.5	4.8	50.8	18.0	44.0	38.3	36.7
22	37.40	1 5/8-18UNEF	38.5	4.8	57.2	20.2	46.0	41.5	39.9
24	40.90	1 3/4-18UNS	38.5	4.8	57.2	20.2	50.8	44.7	43.2
28	46.70	2 -18UNS	40.8	5.6	63.5	22.5	55.0	51.0	49.3
32	53.40	2 1/4-16UN	40.8	5.6	69.8	24.7	62.0	57.4	55.8
36	59.60	2 1/2-16UN	40.8	5.6	82.5	26.9	71.0	63.7	62.0

KDB 070A

Jam nut receptacle for rear panel single hole mounting
threaded rear for accessories

KDB 070G

Same as KDB070A except :
RFI/EMI shielded coil within receptacle shell threaded rear for accessories

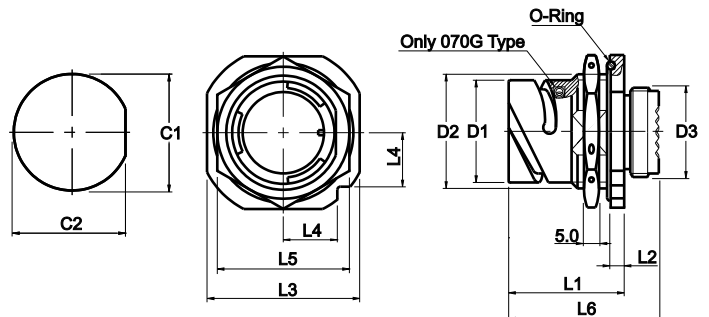

Shell size	∅D1 -0.15	D2 Thread -2A	D3 Thread -2A	L1 max	L2 ±0.1	L3 ±0.4	L4 ±0.1	L5 ±0.4	L6	C1 +0.1	C2 +0.1
10SL	18.20	7/8-20UNEF	9/16-24UNEF	28.5	4.0	31.8	11.2	27.0	37.9	22.4	20.7
12S	21.40	1 -20UNEF	5/8-24UNEF	31.6	4.8	34.9	13.4	30.2	41.0	25.6	23.9
14S	24.60	1 1/8-18UNEF	3/4-20UNEF	31.6	4.8	41.3	14.6	33.0	41.0	28.8	27.1
16S	27.40	1 1/4-18UNEF	7/8-20UNEF	31.6	4.8	44.4	15.7	38.1	41.0	32.0	30.1
16	27.40	1 1/4-18UNEF	7/8-20UNEF	36.9	4.8	44.4	15.7	38.1	47.5	32.0	30.1
18	30.80	1 3/8-18UNEF	1 -20UNEF	38.5	4.8	47.6	16.8	39.7	49.1	35.1	33.4
20	34.20	1 1/2-18UNEF	1 1/8-18UNEF	38.5	4.8	50.8	18.0	44.0	49.1	38.3	36.7
22	37.40	1 5/8-18UNEF	1 1/4-18UNEF	38.5	4.8	57.2	20.2	46.0	49.1	41.5	39.9
24	40.90	1 3/4-18UNS	1 3/8-18UNEF	38.5	4.8	57.2	20.2	50.8	50.7	44.7	43.2
28	46.70	2 -18UNS	1 5/8-18UNEF	40.8	5.6	63.5	22.5	55.0	52.0	51.0	49.3
32	53.40	2 1/4-16UN	1 7/8-16UN	40.8	5.6	69.8	24.7	62.0	53.6	57.4	55.8
36	59.60	2 1/2-16UN	2 1/8-16UN	40.8	5.6	82.5	26.9	71.0	53.6	63.7	62.0

KDB / VG95234 Series

KDB 01E /-F80 VG 95234 Style F

Cable connection plug with cable clamp and telescoping bushing

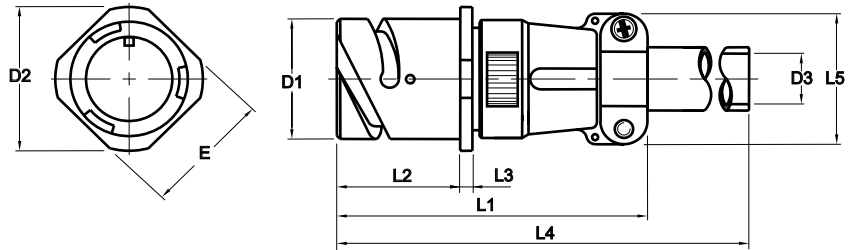

Shell size	∅D1 -0.15	∅D2 max	∅D3 max	E ±0.2	L1 max	L2 +0.4	L3 ±0.2	L4 max	L5 max
10SL	18.20	25.2	5.6	20.6	60	18.2	2.8	120	22.7
12S	21.40	27.8	5.6	23.6	60	18.2	3.2	120	22.7
14S	24.60	29.8	8.0	25.4	62	18.2	3.2	120	27.5
16S	27.40	32.3	11.1	28.6	70	18.2	3.2	120	30.0
16	27.40	32.3	11.1	28.6	70	21.5	3.2	125	30.0
18	30.80	34.8	14.3	31.7	77	23.1	4.0	125	33.0
20	34.20	37.8	15.9	34.9	77	23.1	4.0	125	37.5
22	37.40	41.1	15.9	38.1	77	23.1	4.0	125	37.5
24	40.90	44.6	19.1	41.3	85	23.1	4.0	125	43.3
28	46.70	50.9	19.1	47.6	85	24.1	4.0	125	43.3
32	53.40	57.1	23.8	54.0	85	24.1	4.0	125	51.7
36	59.60	63.6	31.8	60.6	105	24.1	4.0	135	58.0

KDB 01E /-02

Cable connection plug with adapter for heat shrinkable boots

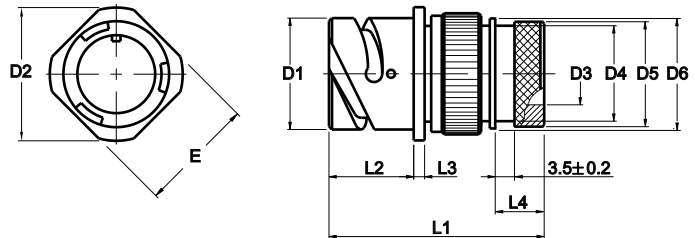

Shell size	∅D1 -0.15	∅D2 max	∅D3 min	∅D4 max	∅D5 ±0.2	∅D6 ±0.2	E ±0.2	L1 max	L2 +0.4	L3 ±0.2	L4 ±0.5
10SL	18.20	25.2	7.7	13.3	15.5	17.0	20.6	57	18.2	2.8	11.7
12S	21.40	27.8	7.9	13.3	15.5	17.8	23.6	57	18.2	3.2	11.7
14S	24.60	29.8	10.6	17.0	19.1	20.1	25.4	57	18.2	3.2	11.7
16S	27.40	32.3	13.5	21.9	23.9	23.5	28.6	57	18.2	3.2	11.7
16	27.40	32.3	13.5	21.9	23.9	23.5	28.6	63	21.5	3.2	11.7
18	30.80	34.8	14.6	21.9	23.9	26.5	31.7	65	23.1	4.0	11.7
20	34.20	37.8	18.7	26.2	29.6	30.2	34.9	68	23.1	4.0	12.7
22	37.40	41.1	20.8	26.2	29.6	33.6	38.1	68	23.1	4.0	12.7
24	40.90	44.6	24.6	34.5	37.8	38.1	41.3	70	23.1	4.0	12.7
28	46.70	50.9	27.0	34.5	37.8	41.4	47.6	71	24.1	4.0	12.7
32	53.40	57.1	33.3	43.6	47.8	48.6	54.0	74	24.1	4.0	15.2
36	59.60	63.6	38.5	43.6	47.8	54.8	60.6	74	24.1	4.0	15.2

KDB / VG 95234 Series

KDB 06E /-F80 VG 95234 Style D

Straight plug with endbell cable clamp and telescoping bushing

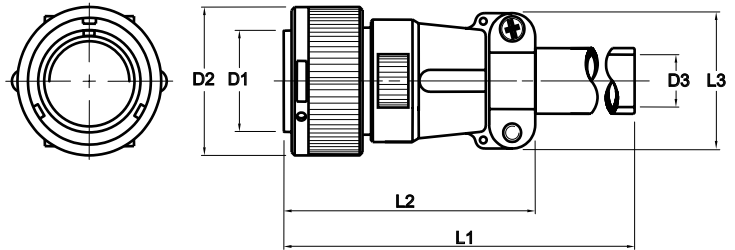

Shell size	∅D1 -0.3	∅D2 max	∅D3 max	L1 max	L2 max	L3 max
10SL	11.3	22.8	5.6	115	55	22.7
12S	14.0	26.0	5.6	115	55	22.7
14S	17.1	29.2	8.0	115	60	27.5
16S	20.4	32.0	11.1	115	60	30.0
16	20.4	32.0	11.1	120	70	30.0
18	23.6	36.5	14.3	120	75	33.0
20	26.7	39.9	15.9	120	75	37.5
22	29.8	43.1	15.9	120	75	37.5
24	33.0	46.6	19.1	120	90	43.3
28	38.6	53.4	19.1	120	90	43.3
32	44.9	60.1	23.8	120	90	51.7
36	50.3	66.3	31.8	130	100	58.0

KDB 06E /-02 VG 95234 Style G

Straight plug with adapter for heat shrinkable boots

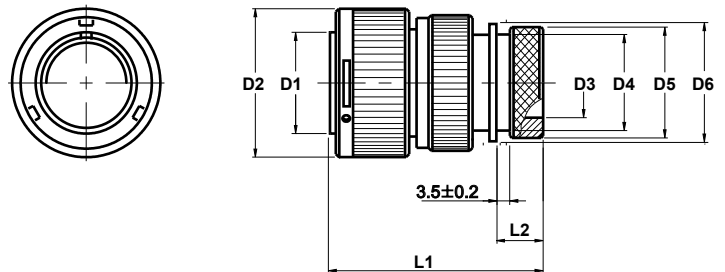

Shell size	∅D1 -0.3	∅D2 max	∅D3 min	∅D4 max	D5 ±0.2	D6 ±0.2	L1 max	L2 ±0.5
10SL	11.3	22.8	7.7	13.3	15.5	17.0	50.0	11.7
12S	14.0	26.0	7.9	13.3	15.5	17.8	50.0	11.7
14S	17.1	29.2	10.6	17.0	19.1	20.1	50.0	11.7
16S	20.4	32.0	13.5	21.9	23.9	23.5	50.0	11.7
16	20.4	32.0	13.5	21.9	23.9	23.5	60.0	11.7
18	23.6	36.5	14.6	21.9	23.9	26.5	60.0	11.7
20	26.7	39.9	18.7	26.2	29.6	30.2	65.0	12.7
22	29.8	43.1	20.8	26.2	29.6	33.6	65.0	12.7
24	33.0	46.6	24.6	34.5	37.8	38.1	65.0	12.7
28	38.6	53.4	27.0	34.5	37.8	41.4	65.0	12.7
32	44.9	60.1	33.3	43.6	47.8	48.6	70.0	15.2
36	50.3	66.3	38.5	43.6	47.8	54.8	80.0	15.2

KDB / VG95234 Series

KDB 06E / -15 VG 95234 Style M

Straight shielded plug with endbell for shielded braids and heat shrinkable boots

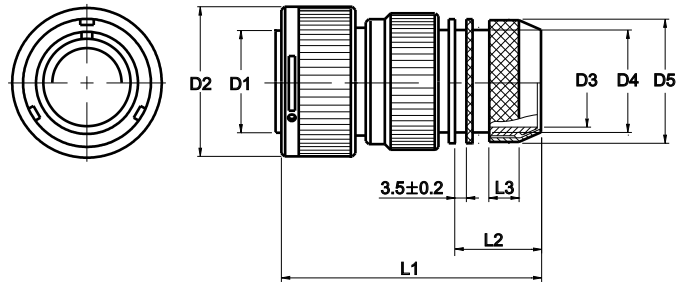

Shell size	∅D1 -0.3	∅D2 max	∅D3 min	∅D4 max	∅D5 +0.5	L1 max	L2 +1.0	L3 ±0.5
10SL	11.3	22.8	7.7	16.3	18.5	55	17.0	7.0
12S	14.0	26.0	9.3	17.0	20.0	55	17.0	7.0
14S	17.1	29.2	10.6	20.0	22.0	55	17.0	7.0
16S	20.4	32.0	13.5	23.0	25.0	60	18.0	8.0
16	20.4	32.0	13.5	23.0	25.0	70	18.0	8.0
18	23.6	36.5	14.6	24.5	28.0	70	18.0	8.0
20	26.7	39.9	18.5	28.5	32.0	70	18.0	10.0
22	29.8	43.1	20.8	30.5	34.0	70	18.0	10.0
24	33.0	46.6	24.6	34.5	38.0	70	18.0	10.0
28	38.6	53.4	27.0	37.5	41.0	70	18.0	10.0
32	44.9	60.1	33.3	44.0	48.0	70	18.0	10.0
36	50.3	66.3	38.5	51.0	55.0	80	18.0	10.0

KDB 08E / -F80 VG 95234 Style E

Plug 90° which is available with cable clamp and bushing

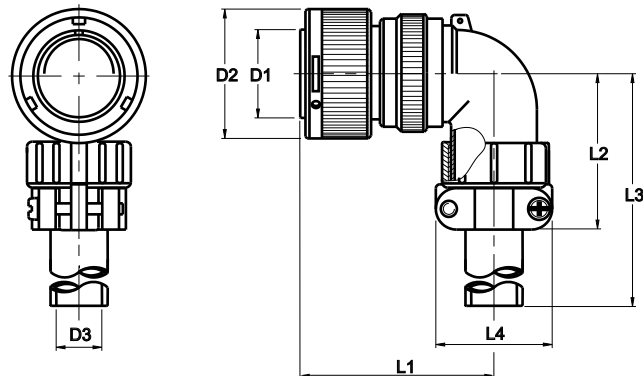

Shell size	∅D1 -0.3	∅D2 max	∅D3 max	L1 max	L2 max	L3 max	L4 max
10SL	11.3	22.8	5.6	45	42	100	22.7
12S	14.0	26.0	5.6	45	42	100	22.7
14S	17.1	29.2	8.0	47	42	100	27.5
16S	20.4	32.0	11.1	48	45	100	30.0
16	20.4	32.0	11.1	57	45	100	30.0
18	23.6	36.5	14.3	58	53	100	33.0
20	26.7	39.9	15.9	61	53	100	37.5
22	29.8	43.1	15.9	61	53	100	37.5
24	33.0	46.6	19.1	66	58	100	43.3
28	38.6	53.4	19.1	66	58	100	43.3
32	44.9	60.1	23.8	72	66	110	51.7
36	50.3	66.3	31.8	75	69	110	58.0

KDB / VG 95234 Series

Accessories

KDB CR

Metal protecting caps
for receptacles shell type
KDB 00, 01 and 02

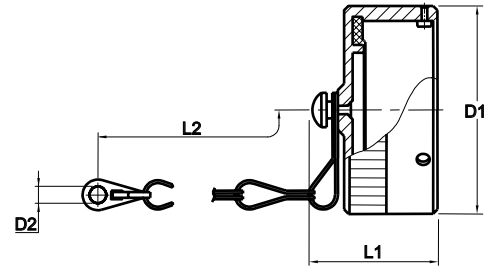

KDB order No.	Shell size	∅ D1 max	∅ D2 +0.2	L1 ±0.3	L2 +10
KDB CR-10	10SL	23.4	4.3	19.5	100
KDB CR-12	12S	26.6	4.3	19.5	100
KDB CR-14	14S	29.8	4.3	19.5	100
KDB CR-16	16S	32.6	4.3	19.5	100
KDB CR-17	16	32.6	4.3	24.5	115
KDB CR-18	18	36.7	4.3	24.5	115
KDB CR-20	20	40.1	4.3	24.5	125
KDB CR-22	22	43.3	4.3	24.5	125
KDB CR-24	24	46.8	4.3	24.5	125
KDB CR-28	28	52.6	5.5	24.5	170
KDB CR-32	32	59.3	5.5	24.5	170
KDB CR-36	36	65.5	5.5	24.5	170

KDB CP

Metal protecting caps for
plugs shell type KDB 06, 08

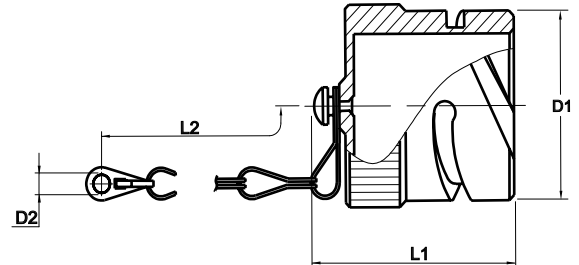

KDB order No.	Shell size	∅ D1 -0.15	∅ D2 +0.2	L1 ±0.3	L2 +10
KDB CP-10	10SL	18.20	4.3	28.5	100
KDB CP-12	12S	21.40	4.3	28.5	110
KDB CP-14	14S	24.60	4.3	28.5	110
KDB CP-16	16S	27.40	4.3	28.5	110
KDB CP-17	16	27.40	4.3	36.5	125
KDB CP-18	18	30.80	4.3	36.5	125
KDB CP-20	20	34.20	4.3	36.5	140
KDB CP-22	22	37.40	4.3	36.5	140
KDB CP-24	24	40.90	4.3	36.5	140
KDB CP-28	28	46.70	5.5	36.5	195
KDB CP-32	32	53.40	5.5	36.5	195
KDB CP-36	36	59.60	5.5	36.5	195

KDB / VG 95234 Series

KDB 05 VG 95234 Style BOD

Front panel and Rear panel mounting
flange with through holes

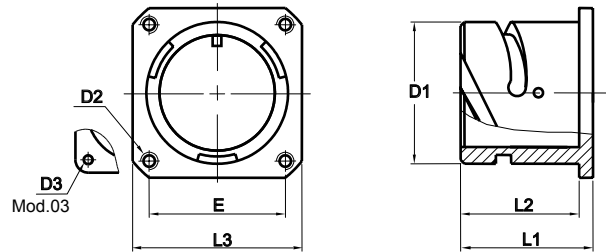

KDB Order No.	Shell size	∅ D1 -0.15	D2	∅ D3 Mod.03	E ±0.1	L1 ±0.2	L2 +0.3	L3 ±0.3
KDB 05-10	10SL	18.20	M4	3.2	18.2	21.1	18.3	25.4
KDB 05-12	12S	21.40	M4	3.2	20.6	21.5	18.3	28.0
KDB 05-14	14S	24.60	M4	3.2	23.0	21.5	18.3	30.0
KDB 05-16	16S	27.40	M4	3.2	24.6	21.5	18.3	32.5
KDB 05-17	16	27.40	M4	3.2	24.6	24.8	21.6	32.5
KDB 05-18	18	30.80	M4	3.2	27.0	27.2	23.2	35.0
KDB 05-20	20	34.20	M4	3.2	29.4	27.2	23.2	38.0
KDB 05-22	22	37.40	M4	3.2	31.8	27.2	23.2	41.0
KDB 05-24	24	40.90	M4	3.7	34.9	27.2	23.2	44.5
KDB 05-28	28	46.70	M5	3.7	39.7	28.2	24.2	50.8
KDB 05-32	32	53.40	M5	4.3	44.5	28.2	24.2	57.0
KDB 05-36	36	59.60	M5	4.3	49.2	28.2	24.2	63.5

Gaskets

Thickness of gaskets
Made of Alu-Flex"2" = 0.7mm
Made of polychloroprene"1" = 1.5mm

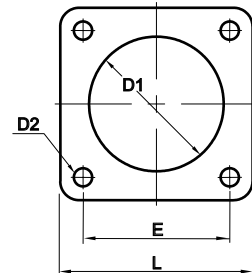

Version A Front panel mounting

KDB Order No.	Shell size	∅D1 +1.0	∅D2 ±0.2	E ±0.1	L ±0.3
KDA 10 -x	10SL	15.7	4.2	18.2	25.4
KDA 12 -x	12S	18.9	4.2	20.6	28.0
KDA 14 -x	14S	22.1	4.2	23.0	30.0
KDA 16 -x	16S&16	25.3	4.2	24.6	32.5
KDA 18 -x	18	28.4	4.2	27.0	35.0
KDA 20 -x	20	31.6	4.2	29.4	38.0
KDA 22 -x	22	34.8	4.2	31.8	41.0
KDA 24 -x	24	38.0	4.2	34.9	44.5
KDA 28 -x	28	44.3	5.1	39.7	50.8
KDA 32 -x	32	50.7	5.1	44.5	57.0
KDA 36 -x	36	57.0	5.1	49.2	63.5

Version B Rear panel mounting

KDB Order No.	Shell size	∅D1 +0.2
KDH 10 -x	10SL	18.2
KDH 12 -x	12S	21.4
KDH 14 -x	14S	24.6
KDH 16 -x	16S&16	27.4
KDH 18 -x	18	30.8
KDH 20 -x	20	34.2
KDH 22 -x	22	37.4
KDH 24 -x	24	40.9
KDH 28 -x	28	46.7
KDH 32 -x	32	53.4
KDH 36 -x	36	59.6

*X= "1"(electrically not conductive) or "2"(electrically conductive)

KDB / VG 95234 Series

Contacts

Pin Contacts

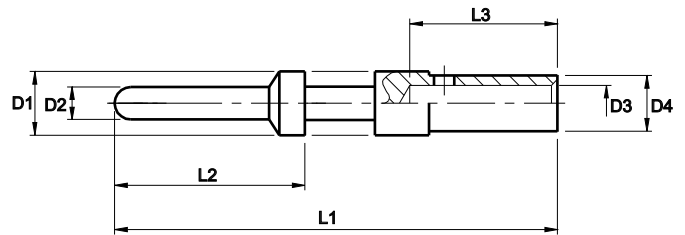

Contact size	$\varnothing D1$	$\varnothing D2$	$\varnothing D3$	$\varnothing D4$	L1	L2	L3
AWG	-0.15	-0.05	+0.05	-0.05	± 0.2	± 0.1	min
20	2.00	1.04	1.50	1.95	28.4	11.3	4.6
16S	3.20	1.60	1.75	2.75	27.4	13.9	6.8
16	3.20	1.60	1.75	2.75	31.4	13.9	6.8
12	4.80	2.40	2.50	3.80	37.0	18.3	6.8
8	7.60	3.60	4.55	6.80	39.6	20.0	12.0
4	11.20	5.75	7.10	9.55	39.6	20.0	12.0
0	15.15	9.10	11.50	14.35	41.0	20.0	14.0

Socket Contacts

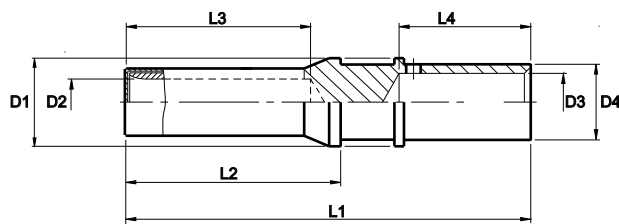

size 8, 4, 0

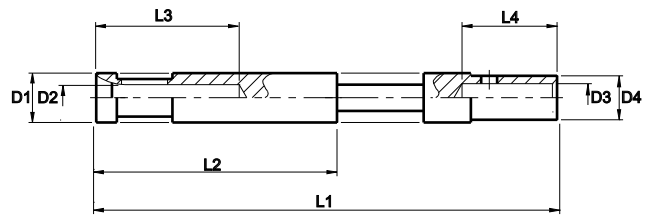

size 20, 16s, 16, 12

Contact size	$\varnothing D1$	$\varnothing D2$	$\varnothing D3$	$\varnothing D4$	L1	L2	L3	L4
AWG	-0.15	+0.05	+0.05	-0.05	± 0.3	± 0.2	min	min
20	2.00	1.07	1.50	1.95	36.8	21.3	7.5	4.6
16S	3.20	1.65	1.75	2.75	29.1	15.1	10.0	6.8
16	3.20	1.65	1.75	2.75	37.8	19.8	10.0	6.8
12	4.80	2.45	2.50	3.80	37.0	19.0	15.0	6.8
8	7.60	3.65	4.55	6.80	40.1	20.6	15.0	12.0
4	11.20	5.80	7.10	9.55	40.1	20.6	15.0	12.0
0	15.15	9.15	11.50	14.35	41.6	20.6	15.0	14.0

KDB / VG 95234 Series

Cross Reference Lists

1. Comparison by item number – KDB, VG, CA Connectors

KDB KDB00E 18-1PN-F80 **VG** VG95234 J1 18-1PN-F80 **CA** CA3100E 18-1PNB-F80

2. Comparison by Wire

AWG (American Wire Gauge)

KDB KDB00E 18-1PN-**F80** VG VG95234 J1 18-1P**1N** CA CA3100E 18-1PNB-**F80**

mm² (Metric)

KDB KDB00E 18-1PN-**01** VG VG95234 J1 18-1PN CA CA3100E 18-1PNB-**01**

AWG (American Wire Gauge)			mm ² (Metric)			Solder Contacts	
KDB	VG	CA	KDB	VG	CA	KDB	CA
KDB00E *-F80	VG95234 J1 ---.1.	CA3100E *B-F80	KDB00E *-01	VG95234 J1 ---.1.	CA3100E *B-01	KDB00E *	CA3100E *B
KDB00E *-05-F80	VG95234 J2 ---.1.	CA3100E *B-05-F80	KDB00E *-01-05	VG95234 J2 ---.1.	CA3100E *B-01-05	KDB00E *-05	CA3100E *B-05
KDB00E *-15	VG95234 N1 ---.1.	CA3100E *B-15	KDB00E *-14	VG95234 N1 ---.1.	CA3100E *B-14	KDB00E *-13	CA3100E *B-13
KDB00E *-05-15	VG95234 N2 ---.1.	CA3100E *B-05-15	KDB00E *-05-14	VG95234 N2 ---.1.	CA3100E *B-05-14	KDB00E *-05-13	CA3100E *B-05-13
KDB00E *-02	VG95234 U1 ---.1.	CA3100E *B-02	KDB00E *-03	VG95234 U1 ---.1.	CA3100E *B-03	KDB00E *-06	CA3100E *B-06
KDB00E *-02-05	VG95234 U2 ---.1.	CA3100E *B-02-05	KDB00E *-03-05	VG95234 U2 ---.1.	CA3100E *B-03-05	KDB00E *-05-06	CA3100E *B-05-06
KDB00E *-32	VG95234 S1 ---.1.	CA3100E *B-32	KDB00E *-05-32	VG95234 S2 ---.1.	CA3100E *B-05-32	KDB00E *-32	CA3100E *B-32
KDB00E *-08-F80		CA3100E *B-08-F80	KDB00E *-01-08		CA3100E *B-01-08	KDB00E *-08	CA3100E *B-08
KDB00E *-09-F80		CA3100E *B-09-F80	KDB00E *-01-09		CA3100E *B-01-09	KDB00E *-09	CA3100E *B-09
KDB00F *-F80		CA3100F *B-F80	KDB00F *-01		CA3100F *B-01	KDB00F *	CA3100F *B
KDB00F *-05-F80		CA3100F *B-05-F80	KDB00F *-01-05		CA3100F *B-01-05	KDB00F *-05	CA3100F *B-05
KDB00F *-08-F80		CA3100F *B-08-F80	KDB00F *-01-08		CA3100F *B-01-08	KDB00F *-08	CA3100F *B-08
KDB00F *-09-F80		CA3100F *B-09-F80	KDB00F *-01-09		CA3100F *B-01-09	KDB00F *-09	CA3100F *B-09
KDB00R *-F80		CA3100R *B-F80	KDB00R *-01		CA3100R *B-01	KDB00R *	CA3100R *B
KDB00R *-05-F80		CA3100R *B-05-F80	KDB00R *-01-05		CA3100R *B-01-05	KDB00R *-05	CA3100R *-05
KDB02E *-F80	VG95234 A ---.1.	CA3102E *B-F80	KDB02E *-01	VG95234 A ---.1.	CA3102E *B-01	KDB02E *	CA3102E *B
KDB020E *							
KDB020G *							
KDB02E *-109	VG95234 B1 ---.1.	CA3102E *B-109	KDB02E *-04	VG95234 B1 ---.1.	CA3102E *B-04	KDB02E *-111	CA3102E *B-111
KDB02E *-05-F80	VG95234 B2 ---.1.	CA3102E *B-05-F80	KDB02E *-01-05	VG95234 B2 ---.1.	CA3102E *B-01-05	KDB02E *-05	CA3102E *B-05
KDB TB *	VG95234 C1 ---.1.	TBF-B	KDB TB *-05	VG95234 C2 ---.1.	TBF-B-05		
KDB07A *-F80						KDB07A *	
KDB070A *-F80						KDB070A *	
KDB070A SB *-15							
KDB070A SBT *-15							
KDB07G *-F80						KDB07G *	
KDB070G *-F80						KDB070G *	
KDB070G SB *-15							
KDB070G SBT *-15							
KDB01E *-F80	VG95234 F ---.1.	CA3101E *B-F80	KDB01E *-01	VG95234 F ---.1.	CA3101E *B-01	KDB01E *	CA3101E *B
KDB01E *-02		CA3101E *B-02	KDB01E *-03		CA3101E *B-03	KDB01E *-06	CA3101E *B-06
KDB01E *-15		CA3101E *B-15	KDB01E *-14		CA3101E *B-14	KDB01E *-13	CA3101E *B-13
KDB01F *-F80		CA3101F *B-F80	KDB01F *-01		CA3101F *B-01	KDB01F *	CA3101F *B
KDB01R *-F80		CA3101R *B-F80	KDB01R *-01		CA3101R *B-01	KDB01R *	CA3101R *B
KDB06E *-F80	VG95234 D ---.1.	CA3106E *B-F80	KDB06E *-01	VG95234 D ---.1.	CA3106E *B-01	KDB06E *	CA3106E *B
KDB06E *-02	VG95234 G ---.1.	CA3106E *B-02	KDB06E *-03	VG95234 G ---.1.	CA3106E *B-03	KDB06E *-06	CA3106E *B-06
KDB06E *-15	VG95234 M ---.1.	CA3106E *B-15	KDB06E *-14	VG95234 M ---.1.	CA3106E *B-14	KDB06E *-13	CA3106E *B-13
KDB06E *-32	VG95234 R1 ---.1.	CA3106E *B-32	KDB06E *-32	VG95234 R2 ---.1.	CA3106E *B-32		
KDB06F *-F80	VG95234 H ---.1.	CA3106F *B-F80	KDB06F *-01	VG95234 H ---.1.	CA3106F *B-01	KDB06F *	CA3106F *B
KDB06F *-15	VG95234 L ---.1.	CA3106F *B-15	KDB06F *-14	VG95234 L ---.1.	CA3106F *B-14	KDB06F *-13	CA3106F *B-13
KDB06R *-F80		CA3106R *B-F80	KDB06R *-01		CA3106R *B-01	KDB06R *	CA3106R *B
KDB08E *-F80	VG95234 E ---.1.	CA3108E *B-F80	KDB08E *-01	VG95234 E ---.1.	CA3108E *B-01	KDB08E *	CA3108E *B
KDB08F *-F80	VG95234 E1 ---.1.	CA3108F *B-F80	KDB08F *-01	VG95234 E1 ---.1.	CA3108F *B-01	KDB08F *	CA3108F *B
KDB08F *-15	VG95234 K ---.1.	CA3108F *B-15	KDB08F *-14	VG95234 K ---.1.	CA3108F *B-14	KDB08F *-13	CA3108F *B-13